

# RussMar Logistics, LLC.

330 Eastern Bypass, Suite Box 309, Richmond, KY 40475

RECEIVED

NOV 20 2013

PUBLIC SERVICE  
COMMISSION

TO: Kentucky Public Service Commission

Attention: Executive Director (Joel Grugin)

211 Sower Blvd

Frankfort, KY 40602

Case No. 2012-00361<sup>362</sup>

November 18, 2013

The following documentation is being submitted by RussMar Logistics, LLC. on behalf of the Tompkinsville Natural Gas System.

## Documents Included:

1. Leak Survey(City): (24 pages)
2. Visual Inspection of Main: (1 page)
3. Leak Repairs: (26 pages)
4. Office Chart Clock: (18 pages)
5. Public Awareness Meeting(s): (Oct 1 & Oct 24)

\*A hard copy of the above mentioned documents were mailed to the Kentucky Public Service Commission, Attention Executive Director on November 18, 2013 by Joe Orazen of RussMar Logistics, LLC.

Sincerely,

Joe Orazen



**Joe Orazen**  
*Operations Manager*

2371 Irvine Rd. Richmond, KY 40475

CAP FOR CLEANOUT BY Jct 2160 sign  
IN FRONT OF FIELDS

JANSEN

3<sup>rd</sup> St 202 House cross from BUTERS Bottom of Regulator

208 ROSE Hill - Street 90 Inlet side

206 2<sup>nd</sup> St - TOP OF LOCK VALVE

Board of Education Old High Building - TOP OF Reducer  
401 W 4<sup>th</sup> St ✓ Inlet side

Board of Education Old High School Front of Building  
401 W 4<sup>th</sup> Bottom of Union Inlet side

TOMPKINSVILLE Church of Christ - 2<sup>nd</sup> 90 Front  
MAIN STREET Bottom of LOCK VALVE ✓

THOMAS Hill - CLAMP ON RISER  
MANHOLE 601 ✓

519<sup>N</sup> MAIN St - POSSIBLE TAP AT ROAD next  
TO SIDE WALK ✓

Mc DONALD'S MAIN St. - TOP OF REGULATOR  
508 N MAIN ✓ TOP OF LOCK VALVE

WHITE St. BY 514 where WATER TAP WAS  
Dug out 7<sup>ft</sup> OFF Meter ✓

Thurs  
noon

Michael Smith.

701 Montpelier Drive - Inground At Riser

302 Paige St - Bottom Lock Valve

~~EAST Shore + Montpelier Dr~~  
Luttrell

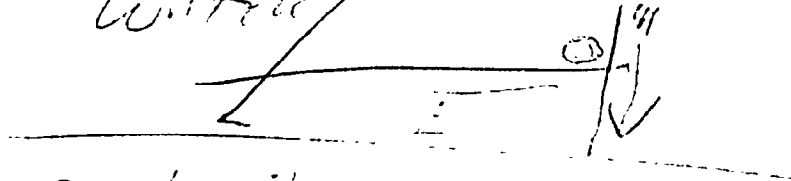

Peck & Red

60 W 6<sup>th</sup> St - TOP OF LOCK VALVE ✓

508 4<sup>th</sup> Blvd - Inground ✓

405 4<sup>th</sup> Blvd - TOP LOCK VALVE ✓

407 4<sup>th</sup> Blvd - TOP LOCK VALVE ✓

507 4<sup>th</sup> Blvd - SPUD LEAKING MAIN AND WASH ✓

408 6<sup>th</sup> St. - Front of House AHEAD where  
ALREADY BEEN DUG 25<sup>ft</sup> FROM DRIVE ✓  
AND COMING OUT AT edge OF YARD Behind  
Bricks

412 6<sup>th</sup> St. BOTTOM OF REGULATOR ✓

CASTLE HEIGHTS ROAD - 100<sup>ft</sup> FROM STOP SIGN AT  
Emberton St TOWARD RICKY RICHARDSON ✓

FRANK 112 MASSINGLO Inground 3<sup>ft</sup> FROM FENCE



Address: 302 Prairie St City/County: Tompkinsville KY State: KY Date: 2/8/13

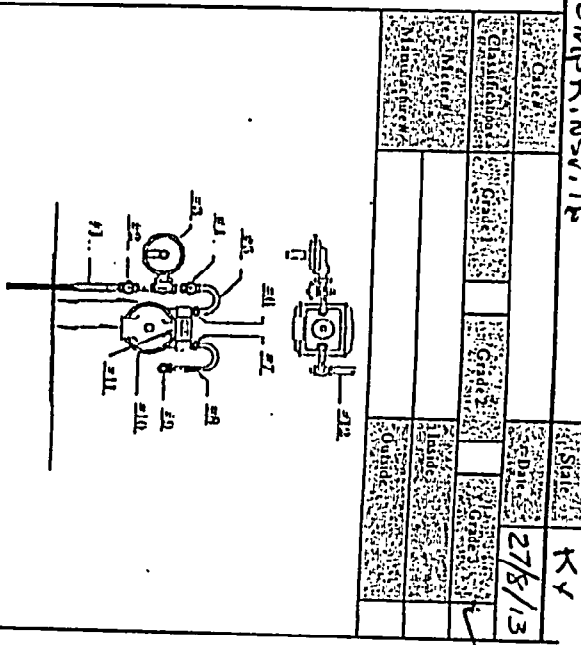

LEAK ON BOTTOM OF LOCK VALVE

ID/Defect	Location	Material	Size	Code	Notes
	Mobile RT	Inlet Bldg	N/A		
	Flame Pail	Outside Bldg	Service		
	Vessel	Mechanic	Tap		
	CGUCGD	Underground	Valve		
	Small	Atmosphere	Meter		
	Corrosion	Pipe			
	Outside Ferris	Valve	Lock		
	Cond/Defect	Fitting			
	Material Defect	Regulator			
	Other	Tap Connection			

Material	Code	Notes
Mobile RT		
Flame Pail		
Vessel		
CGUCGD		
Small		
Corrosion		
Outside Ferris		
Cond/Defect		
Material Defect		
Other		

  

Material	Code	Notes
Mobile RT		
Flame Pail		
Vessel		
CGUCGD		
Small		
Corrosion		
Outside Ferris		
Cond/Defect		
Material Defect		
Other		



Address: **Main St Church & Christ** City/Town: **Chrysoth** State: **KY**

**LEAK ON 90' VAD TO STEPS INVERT SIDE**

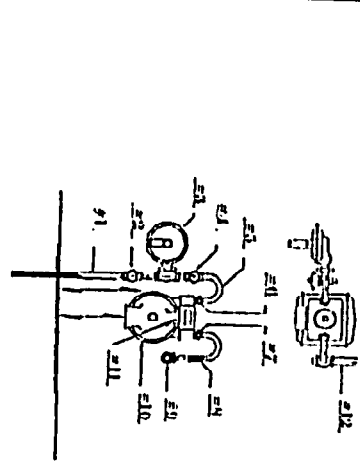

#1 Ruler	#2 HP Cock	#3 Regulator
#4 LP Cock	#5 Inlet Loop	#6 Inlet Cap/Swivel
#7 Out Cap/Swivel	#8 Outlet Loop	#9 Full Line Fitting
#10 Cu Niter	#11 Index	#12 Full Line

Direction	Location	Soil Sub	CC/EGD	Prod	Surface	Pipe	Size	Weather
Mobile PI	Inside Bldg	Mud		(0-1)	Grass	Steel	5-120	Clear
Flame Pk	Outside Bldg	Service	LEL	(1-20)	Dirt	PE	20-120	Wd
Visual	Manhole	Trip	UEL	(1-40)	Asphalt	Cu Line	10-140	Ht (85-100)
CC/EGD	Undergnd	Valve	PPM	(61-95.3)	Concrete	CSST	60-80	Cd4 (0-4)
Soil	Atmosphere	Niter		(100-339)	Sidewalk	PVCB	100-120	
Leak Cause?	Component/Explanation	Part of System	Type Material	Location Area	Repair Date			
Corrosion	✓ Pipe	✓ Transmission	Steel	Residential	1-5	Bar		
Outside Force	Valve	Mish	Cu Line	Rural	5-Crawler	Card		
Cam/Defect	Fitting	Service	Ductile Iron	Commercial	Date Repaired:			
Material Defect	Regulator	Miter Set	Copper	Industrial	Date Rechecked:			
Other	Tap Connection	Customer Pipe	Plastic					

Address: 401 W 4th Street City/County: Tompkins Co. NY State: NY Date: 08/18/13



LEAK ON UNION AT RISER

Classification	Grade 1	Grade 2	Grade 3
Meter #			
Manufacturer #			
	Inside	Outside	

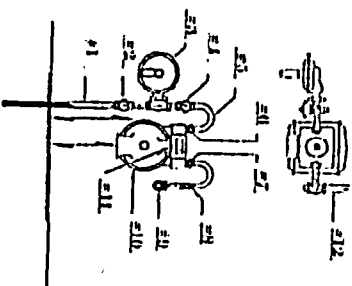

#1 Riser	#2 Inlet Cock	#3 Regulator
#4 Inlet Capswivel	#5 Inlet Loop	#6 Inlet Capswivel
#7 Outlet Capswivel	#8 Outlet Loop	#9 Fuel Line Fitting
#10 Gas Meter	#11 Index	#12 Fuel Line

Detection	Location	Soil Sub	CGI/CD	Feature	Surface	Pipe	Weather
Mobile Ft	Inside Bldg	Main		(0-1)	Grass	Steel	Clear
Flame Path	Outside/Bldg	Service		(1-30)	Dirt	PE	Wet
Visual	Mainhole	Tap		(01-60)	Asphalt	Cul Inne	Hot (85-100)
CGI/CD	Underground	Valve		(61-99.9)	Concrete	CST	Cold (0-40)
Soil	Atmosphere	Meter		(100-999)	Sidewalk	PVCB	
Leak Code	Component/Explanation	Part of System	Time	Material	Location Area	Repair Data	
Corrosion	✓ Pipe	Transmission	Steel	Residential		L-5	Bar
Outside Force	Valve	Main	Cast Iron	Rural		S-Crawler	Coat
Condu/Duct	Fitting	Service	Ductile Iron	Commercial		Date Replaced:	
Material Defect	Regulator	Meter Set	Copper	Industrial		Date Replaced:	
Other	Tap Connection	Customer Pipe	Plastic				



Address: 401 W 4th Street  
 Old AC Buildings  
 High School

City/County

Templesville

State: KY  
 Date: 2/6/13

LENK ON TOP OF REDUCER ON INVERT SIDE

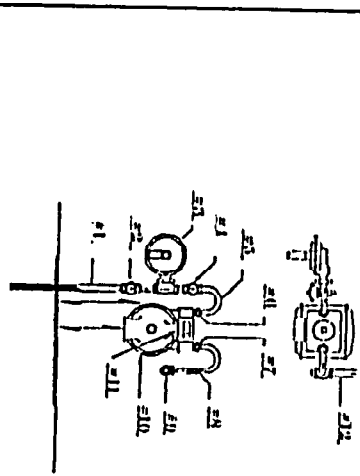

#1 Ruler	#2 HP Cock	#3 Regulator
#4 LP Cock	#5 Inlet Loop	#6 Inlet Cap/Swivel
#7 Out Cap/Swivel	#8 Outlet Loop	#9 Fuel Line Fitting
#10 Gas Meter	#11 Index	#12 Fuel Line

Material	Location	Soil Sub	CGUECD	Pressure	Surface	Pipe	Weather
Mable FT	Inside Bldg	Misa		(4-1)	Grass	Steel	Clear
Flame Pkts	Outside Bldg	Service	LEL	(1-30)	Dirt	PE	Wd
Visual	Manhole	Tap	UEL	(31-60)	Asphalt	Cur line	10-4-0
CGUECD	Undergrnd	Valve	PPM	(61-99)	Concrete	CSST	10-4-0
Sand	Atmosphere	Meier		(100-399)	Sidewalk	PVCB	10-4-12-0
Cerulosa	Pipe	Transmission	Steel	Residential	Location Area	Repair Dis	
Outside Force	Valve	Misa	Cur line	Rural		1-5	Bur
Caust/Detect	Fitting	Service	Durable foam	Commercial		5-Grater	Card
Material Detect	Regulator	Meier Set	Copper	Industrial		Date Required:	
Other	Trap Connection	Customer Pipe	Plastic			Date Rechecked:	



Address: 206 2nd Street  
 City/County: Tompkinsville  
 State: KY  
 Date: 5/8/13

LEAK ON TOP OF LOCK VALVE

Detection	Location	Material	Pressure	Grade	Material	Size	Depth	Other
Visible	Outside Bldg	Service	Gas	(4-1)	Cast Iron	5-120	4-10	✓
Visible	Manhole	Tap	Gas	(1-10)	PE	2.0-3.0	2.0-3.0	✓
Visible	Underground	Valve	Gas	(31-40)	Cast Iron	3.0-4.0	Hot (15-100)	✓
Visible	Atmosphere	Meter	Gas	(100-399)	Stainless Steel	4.0-1.0	Cast (0-10)	✓
Visible	Underground	Meter	Gas	(100-399)	PVCB	1.0-1.10		
Visible	Underground	Tap	Gas	(1-10)	PE	2.0-3.0	2.0-3.0	✓
Visible	Underground	Valve	Gas	(31-40)	Cast Iron	3.0-4.0	Hot (15-100)	✓
Visible	Atmosphere	Meter	Gas	(100-399)	Stainless Steel	4.0-1.0	Cast (0-10)	✓
Visible	Underground	Meter	Gas	(100-399)	PVCB	1.0-1.10		
Visible	Underground	Tap	Gas	(1-10)	PE	2.0-3.0	2.0-3.0	✓
Visible	Underground	Valve	Gas	(31-40)	Cast Iron	3.0-4.0	Hot (15-100)	✓
Visible	Atmosphere	Meter	Gas	(100-399)	Stainless Steel	4.0-1.0	Cast (0-10)	✓
Visible	Underground	Meter	Gas	(100-399)	PVCB	1.0-1.10		

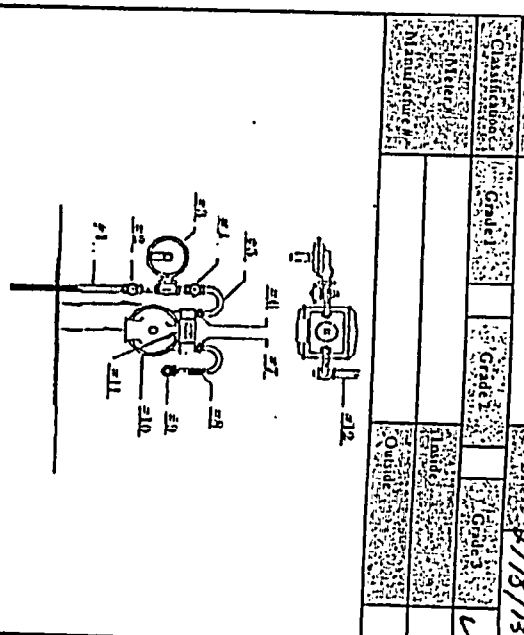

- #1 Riser
- #2 Inlet
- #3 Outlet
- #4 LP Cock
- #5 Inlet Loop
- #6 Inlet Capswivel
- #7 Outlet Capswivel
- #8 Outlet Loop
- #9 Fuel Line Fitting
- #10 Gas Meter
- #11 Inlet
- #12 Fuel Line

Material	Grade	Depth	Other
Cast Iron	Grade 1	Grade 3	Grade 3
PE	Grade 1	Grade 3	Grade 3
Cast Iron	Grade 1	Grade 3	Grade 3
Stainless Steel	Grade 1	Grade 3	Grade 3
PVCB	Grade 1	Grade 3	Grade 3

Material	Grade	Depth	Other
Cast Iron	Grade 1	Grade 3	Grade 3
PE	Grade 1	Grade 3	Grade 3
Cast Iron	Grade 1	Grade 3	Grade 3
Stainless Steel	Grade 1	Grade 3	Grade 3
PVCB	Grade 1	Grade 3	Grade 3

Address: 208 ROSE HILL

City/County: Tompkinsville

State: KY



Case #		Date	9/8/13
Client #		Grade 1	
Client #		Grade 2	
Client #		Grade 3	
Meter #		Grade 1	
Meter #		Grade 2	
Meter #		Grade 3	
Meter #		Grade 1	
Meter #		Grade 2	
Meter #		Grade 3	

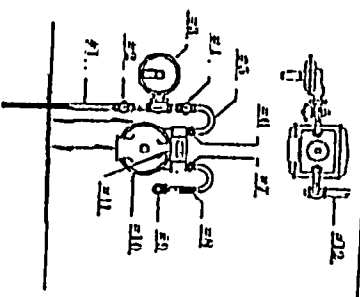

#1 Meter	#2 HP Cock	#3 Regulator
#4 LP Cock	#5 Inlet Loop	#6 Inlet Capswivel
#7 Out Capswivel	#8 Outlet Loop	#9 Fuel Line Fitting
#10 Cu Meter	#11 Inlet	#12 Fuel Line

STREET 90' ON INLET SIDE

Defect	Location	Soil Sub	Color	Pressure	Surface	Pipe	Size	Material
Mobile FI	Inside Bldg	Main	Black	(p-1)	Grass	Steel	5.20	Clear
Turn Park	Outside Bldg	Service	Center	(1-30)	Dirt	PE	2.01A	Wt
Visual	Manhole	Tap	Clay	(31-60)	Asphalt	Cul Insa	1.0-4.0	141 (15-10)
CGI/CD	Underground	Valve	Loam	(61-99.9)	Concrete	CSST	6.4A.0	CSST (6-4)
Small	Atmosphere	Meter	Sand	(100-399)	Stipewalk	PVCB	10.0-11.0	
Ceramics	Pipe	Transmission	Steel		Rudimentary		1.5	Br
Outside Force	Valve	Main	Cul Insa		Rural		5.0-6.0	Cast
Chem/Detect	Fitting	Service	Ductile Iron		Commercial			
Material Defect	Regulator	Meter Set	Copper		Industrial			
Other	Tap Connection	Customer Pipe	Steel					

Address: **House 202 Jackson St** City/County: **Town of Knoxville** State: **KV**



Gate #	Grade 1	Grade 2	Grade 3	Date: <b>27/8/13</b>
Manufacturer #				

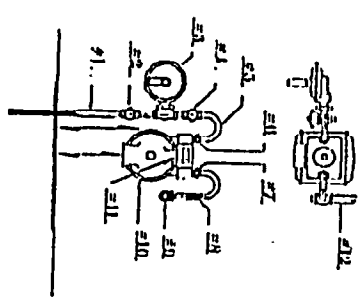

**LEAK ON BOTTOM OF REGULATOR**

Defect	Location	Material	Pressure	Notes
Mobile FI	Inside Bldg	None	(0-1)	Gas
Flame Pack	Outdoorside	Service	(1-30)	Dirt
Visual	Manhole	Tap	(31-60)	Asphalt
CGUECD	Undergrad	Valve	(61-99)	Concrete
Seal	Atmosphere	Meter	(100-399)	Stewalk
Leak Class	Component/Location	Material	Type	Notes
Corrosion	Pipe	Transmission	Steel	Residential
Outside Fitter	Valve	None	Cut Ins	Rural
Crack/Defect	Fitting	Service	Doubt Iron	Commercial
Material Defect	Regulator	Meter Set	Copper	Industrial
Other	Tap Connection	Customer Pipe	Plastic	Date Rechecked:

#1 Riser	#2 HP Cock	#3 Regulator
#4 LP Cock	#5 Inlet Loop	#6 Inlet Capswivel
#7 Out Capswivel	#8 Outlet Loop	#9 Fuel Line Fitting
#10 Gas Meter	#11 Inlet	#12 Fuel Line

Address: 112 Castle Hoyt Road

Temp Kinrossville

State: KY  
Date: 8-28-13

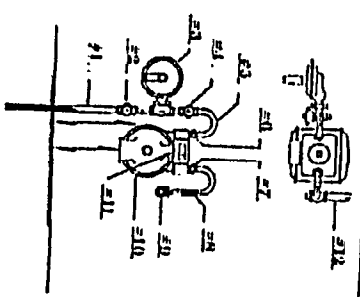
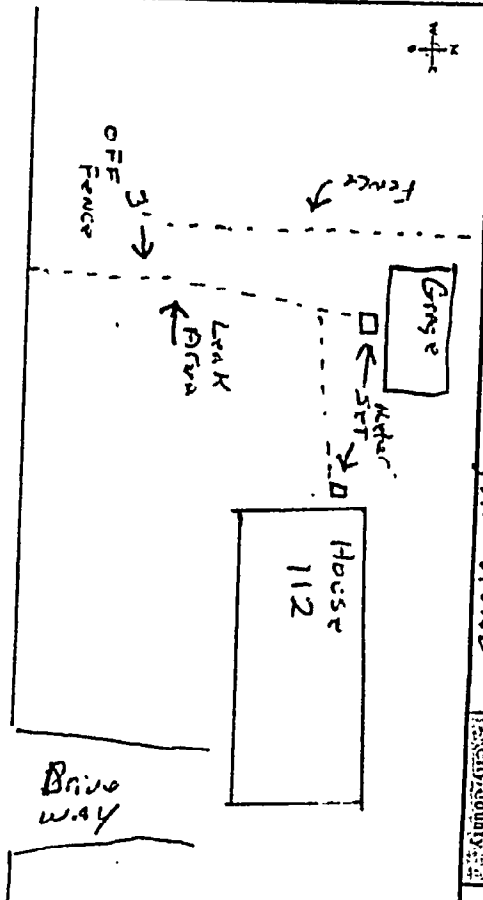

Castle Hoyt Road

Location	Material	Quantity	Notes
Gas	Steel	?	
Di	PE	?	
Alphalt	Cur Iron	3A-4A	
Cemrete	CST	4A-10	
Stewalk	PVCB	1A-12A	
Residential	Residential	1-5	
Rural	Rural	S-Creter	
Commercial	Commercial	Date Repaint:	
Industrial	Industrial	Date Repaint:	

Part	Material	Quantity	Notes
#1 Riser	Steel	?	
#2 IIP Cock	Steel	?	
#3 Regulator	Clay		
#4 LP Cock	PE	2A-3A	
#5 Inlet Loop	W/I		
#6 Inlet Cap/Swivel	W/I		
#7 Out Cap/Swivel	W/I		
#8 Outlet Loop	W/I		
#9 Fuel Line Fitting	W/I		
#10 Gas Meter	W/I		
#11 Inlet	W/I		
#12 Fuel Line	W/I		

Material	Location	Material	Quantity	Notes
Manhole PT	Manhole	Manhole	(1-1)	
Flange Patch	Manhole	Manhole	(1-30)	
Visual	Manhole	Manhole	(1-40)	
COLECO	Undergrad	Undergrad	(61-592)	
Seal	Atmosphere	Atmosphere	(180-319)	
Carolina	Pipe	Tranmission	Steel	
Outside Fence	Valve	Man	Cur Iron	
Caust/Detect	Fitting	Service	Decide Iron	
Material Detect	Regulator	Meter Set	Copper	
Other	Tap Connection	Customer Pipe	Plastic	

Address

Castle Height Road

County

Temp. Riv. 116

State KY

828-13



Emburton ST

← 100 FT →  
Leak Area

Castle Height RD

Taylor

Grade 1	Grade 2	Grade 3	Grade 4

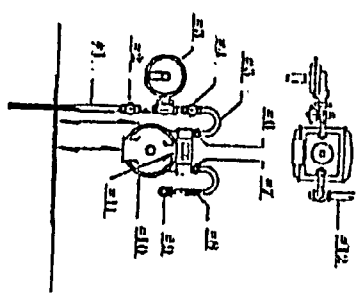

#1 River	#2 1/2" Cock	#3 Regulator
#4 LP Cock	#5 Inlet Loop	#6 Inlet Capswivel
#7 Out Capswivel	#8 Outlet Loop	#9 Fuel Line Fitting
#10 Gas Meter	#11 Inlet	#12 Fuel Line

Detection	Location	Main	Bank	% Gas	CGI/CD	Size	Material	Notes
✓	Inside Bldg	✓	Bank	(0-1)		Steel	Steel	
	Outside Bldg		Center	(1-50)		PE	PE	
	Manhole	Top	Clay	✓ UEL	(11-60)	Cast Iron	Cast Iron	
	Undergrad	✓ Valve	Laam	PPM	(01-92.9)	Cast Iron	Cast Iron	
	Atmosphere	Meter	Sand		(100-399)	FVCE	FVCE	
Leak Cause	Component/Location							100-120
Corrosion	✓ Pipe		Transmission					Repair Date
Outside Face	Valve		Main			Steel	Cast Iron	1-5
Caust/Direct	Fitting		Service			Cast Iron	Cast Iron	5-Creaser
Material Detect	Regulator		Meter Set			Copper	Copper	Date Replaced:
Other	Tap Connection		Customer Pipe			Plastic	Plastic	

Address: 412 6th Street

City/County: Tompkinsville

State: KY

Date: 8-25-13



LEAK AT BOTTOM OF REGULATOR

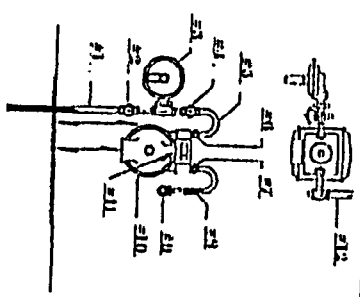

Detector	Lead Bldg	Alfa	Back	% Gas	CG/EGD	Pressure	Gas	Steel	5-12	Clear	Weather
Flame Pack	<input checked="" type="checkbox"/>	Outside/In	Service	✓	✓	CEL	Dirt	FE	2A-13	Wid	
Visual	Manhole	Tap	Clay	UEL		(11-40)	Asphalt	Cur Iron	3A-13		
CG/EGD	Undergrad	Valve	Lam	PPM		(11-39.9)	Concrete	CSST	6A-13		
Small	Atmosphere	Meter	Steel			(100-319)	Stainless	PVCB	10A-11A		
Generation	<input checked="" type="checkbox"/>	Pipe	Transmission	Steel			Residential		15	Bire	
Outside Fence	Valve		Main	Cast Iron			Rural		5-Creaner	Cast	
Cond/Deck	Fitting		Service	Ductile Iron			Commercial		Date Reprints:		
Material Direct	Regular		Meter Set	Copper			Industrial		Date Recheck:		
Other	Tap Connections		Customer Pipe	Plastic							

#1 River	#2 IIP Cock	#3 Regulator
#4 IP Cock	#5 Inlet Loop	#6 Inlet Cap/Swivel
#7 Out Cap/Swivel	#8 Outlet Loop	#9 Fuel Line Fitting
#10 Gas Meter	#11 Inlet	#12 Fuel Line

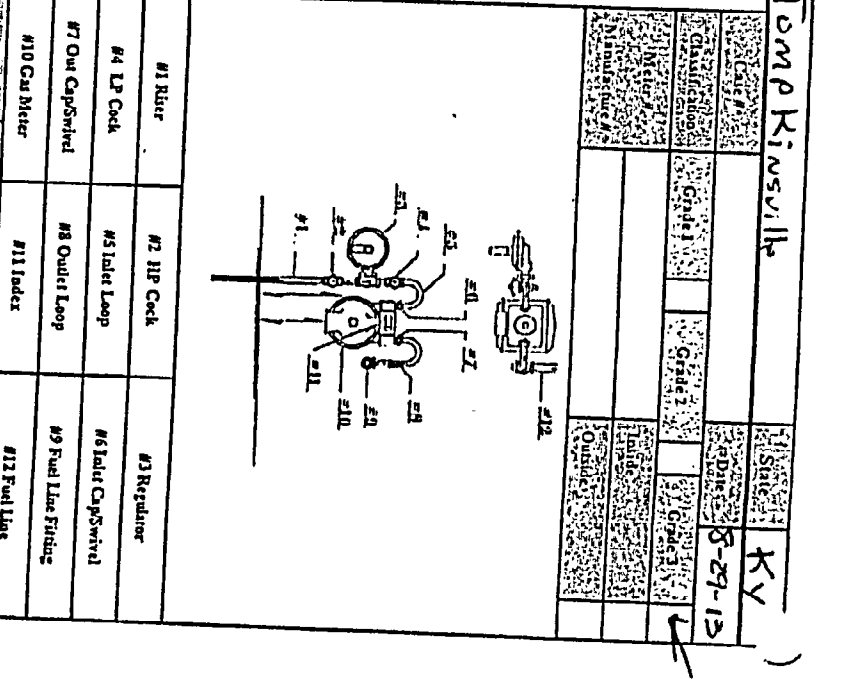
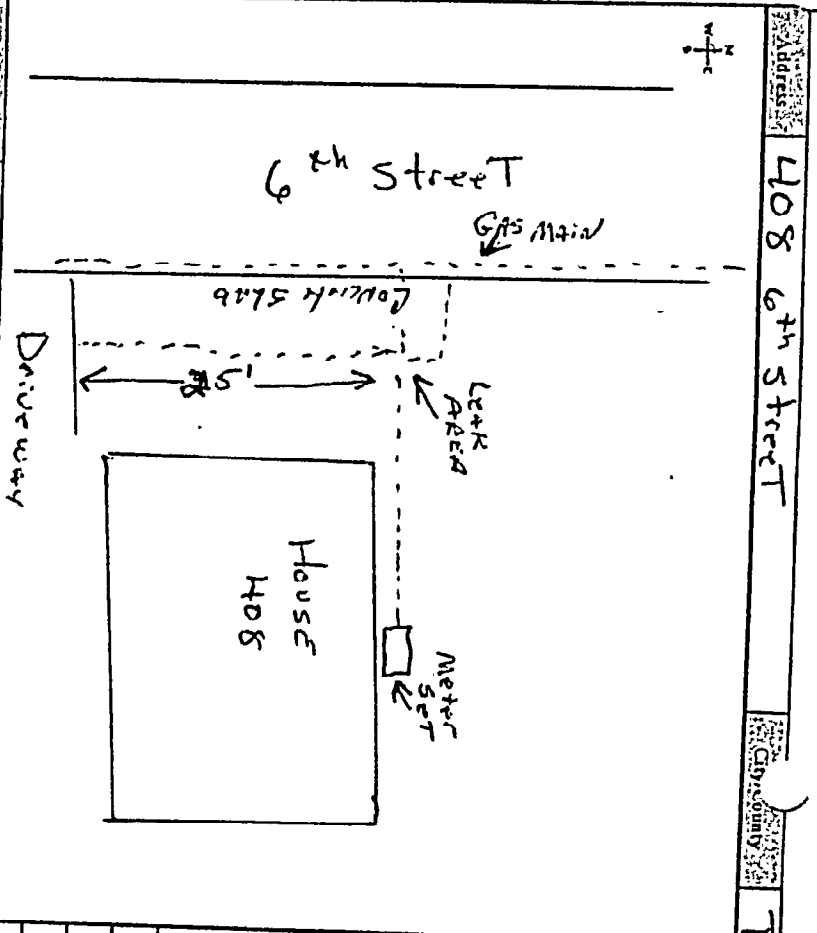

Material			Type			Location		Notes		
Mobile FT	Inlet Bldg	Main	Cast Iron	UTL	(8-1)	Grass	Steel	520	Clear	
Flame Park	Outside Bldg	Service	Cast Iron	UTL	(1-36)	Dirt	PE	2.1-3.0	Wk	
Visual	Main	Tap	Cast Iron	UTL	(1-63)	Asphalt	Cast Iron	1.4-1.0	104 (15-10)	
CG/UCD	Underground	Valve	Cast Iron	UTL	(11-93.3)	Concrete	CSST	6.8-8.0	Cold (0-49)	
Small	Atmosphere	Meter	Cast Iron	UTL	(110-399)	Sidewalk	PVC	10.0-12.0		
Cast Iron	Transmission	Main	Cast Iron	UTL	(110-399)	Grass	Steel	520	Clear	
Outside Force	Valve	Main	Cast Iron	UTL	(110-399)	Grass	Steel	520	Clear	
Cast/Iron	Fitting	Service	Cast Iron	UTL	(110-399)	Grass	Steel	520	Clear	
Material Defect	Regulator	Meter Set	Cast Iron	UTL	(110-399)	Grass	Steel	520	Clear	
Other	Tap Connection	Customer Pipe	Cast Iron	UTL	(110-399)	Grass	Steel	520	Clear	

5-29-13

KY

Tompkinsville

408 6th Street





Address: 507th 4th Blvd

City/Town: Chrysum

Tompkinsville

State: KY

Date: 8-28-13

Classification	Grade 1	Grade 2	Grade 3
Meter			
Outlet			

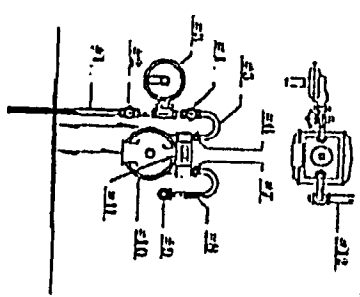

LEAK ON SPUD INLET

Description	Location	Material	Soil Sub	CGI/EGD	Depth	Surf	Size	Weather
Metal PT	Inlet Blde	None	Rock		(4-1)	Grass	Steel	Clear
Flange Pack	Outside Blde	Service	Gravel	LEL	(1-30)	Dirt	PE	2A-1A
Visual	Manhole	Tap	Clay	UEL	(21-40)	Asphalt	Cast Iron	3B-4D
CGI/EGD	Underground	Valve	Lamin	PPM	(41-92.9)	Concrete	CSST	4B-8-0
Soils	Atmosphere	Meter	Sand		(100-399)	Sidewalk	PVC	1A-0-12A
Corrosion	Pipe	Transmission	Steel			Residential		1-5
Outside Force	Valve	Main	Cast Iron			Rural		5-Crusher
Caution	Fittings	Service	Ductile Iron			Commercial		Cast
Material Defect	Regulator	Meter Set	Copper			Industrial		Date Replaced:
Other	Tap Connections	Customer Pipe	Plastic					Date Replaced:

Address: 407 4th Blvd  
 City: Tompkinsville  
 State: KY  
 ZIP: 40387



LEAK ON TOP OF LOCK VALVE

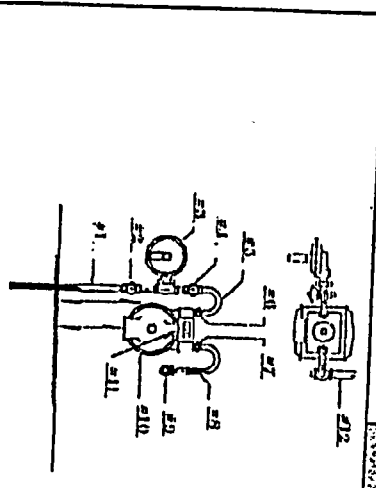

Detection	Inside Bldg	Main	Rack	% Gas	SC/EGD	Pressure	Gas	Steel	Size	Color
Flame Park	Outside/Bldg	Service	Center	LEL	(1-30)	DM	FE	✓	5/30	Blue
Visual	Manhole	Tap	City	UEL	(31-60)	Alphalt	Cast Iron	✓	3.0-4.0	White
CC/EGD	Underground	Valve	Lease	PPM	(61-99.9)	Concrete	CSST	✓	6.0-8.0	Black (65-100)
Sand	Atmosphere	Meter	Sand		(100-399)	Steward	PVC	✓	10.0-12.0	Red (9-4)
Corrosion	✓ Pipe	Transmission	Steel			Residential	1.5	✓	Bar	
Outside Force	Valve	Main	Cast Iron			Commercial	5-Creaner	✓	Cast	
Case/Deduct	Fitting	Service	Device Iron			Industrial	Date Replaced:			
Material Deduct	Regulator	Meter Sd	Copper	✓						
Dobr	Tap Connection	Customer Pipe	Practic							

#1 Riser	#2 Inlet Cock	#3 Regulator
#4 Inlet Loop	#5 Inlet Capswivel	#6 Inlet Capswivel
#7 Outlet Capswivel	#8 Outlet Loop	#9 Fuel Line Fitting
#10 Gas Meter	#11 Index	#12 Fuel Line

Address: 405 4th Blvd City/County: Ompkissville State: KY



Classification	Grade 1	Grade 2	Grade 3
Manufacturer			
Location	Inside	Outside	
Material			
Year			
Model			
Serial			
Notes			

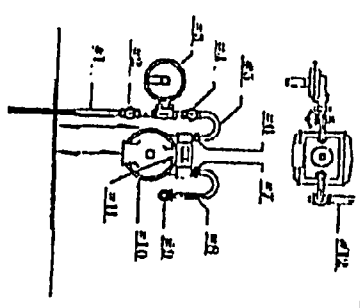

LEAK ON TOP OF LOCK VALVE

Detection	Location	Material	CGI/ECD	% Gas	CGI/ECD	Material	Location	Material	Repair
Mobile FT	Inside Bldg	None		(0-1)		Steel	Residential	1-5	Bar
Plumb Pack	Outside Bldg	Service		(1-30)		PE	Rural	5-Greater	Cable
Visual	Manhole	Tap		(11-40)		Cast Iron	Commercial	Date Replaced:	
CGI/ECD	Underground	Valve		(01-99.9)		CSST	Industrial	Date Replaced:	
Sand	Atmosphere	Meter		(100-399)		PVCB			
Leak	Component/Location								
CGI/ECD	Transmission					Steel	Residential	1-5	Bar
Outside Fence	Valve					Cast Iron	Rural	5-Greater	Cable
Cast/Duct	Fitting					Ductile Iron	Commercial	Date Replaced:	
Material Defect	Regulator					Copper	Industrial	Date Replaced:	
Other	Tap Connections					Plastic			

#1 Meter	#2 HP Cock	#3 Regulator
#4 LP Cock	#5 Inlet Loop	#6 Inlet Cap/Spring
#7 Out Cap/Spring	#8 Outlet Loop	#9 Fuel Line Fitting
#10 Gas Meter	#11 Inlet	#12 Fuel Line

Address: 508 4th Blvd  
 Division: Tompkinsville  
 City: Tompkinsville  
 State: KY  
 Zip: 40367  
 Date Rec'd: 8-25-13

IN Ground LEAK

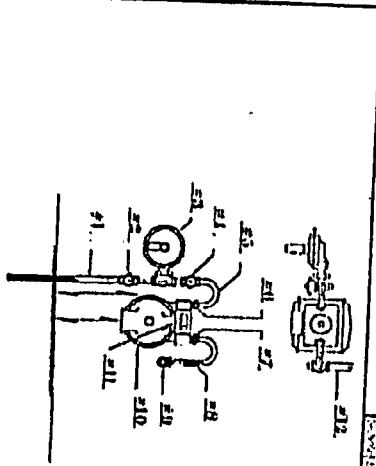
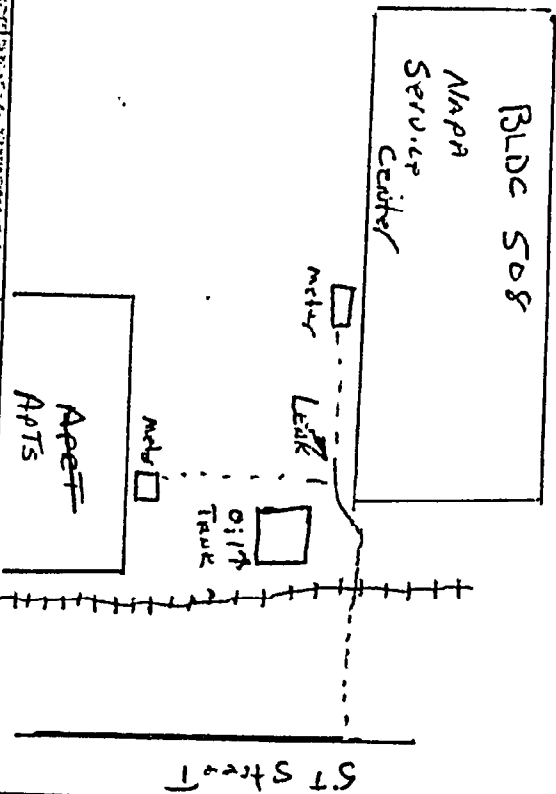

Material	Quantity	Notes	Material	Quantity	Notes
Cast Iron	1		Cast Iron	1	
Steel	1		Steel	1	
Plastic	1		Plastic	1	
Other	1		Other	1	

Material	Quantity	Notes	Material	Quantity	Notes
Cast Iron	1		Cast Iron	1	
Steel	1		Steel	1	
Plastic	1		Plastic	1	
Other	1		Other	1	

Material	Quantity	Notes	Material	Quantity	Notes
Cast Iron	1		Cast Iron	1	
Steel	1		Steel	1	
Plastic	1		Plastic	1	
Other	1		Other	1	

Material	Quantity	Notes	Material	Quantity	Notes
Cast Iron	1		Cast Iron	1	
Steel	1		Steel	1	
Plastic	1		Plastic	1	
Other	1		Other	1	



Address: 601 Magnolia St  
 City/County: Town of Kimsu, Va  
 State: KY  
 Date: 28/8/13



Call #	Grade 1	Grade 1	Grade 1
Classification	Grade 1	Grade 1	Grade 1
Meter	Inside	Outside	
Meter Location			

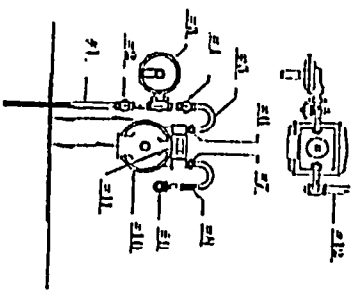

CLAMP ON RISER

Detection	Location	Material	Soil Sub	% Gas	CGI/CEP	Pressure	Surf	Pipe	Size	Depth	Weather
	Indide Bldg	Misa	Rack			(p-1)	Grass	Steel	5-20	Gas	
	Outside Bldg	Service	Cadfr	LEL		(1-3)	Dirt	PE	20-30	Wd	
	Manhole	Trap	Clay	UEL		(1-40)	Asphalt	Cur Line	30-40	104 (85-100)	
	Undergrnd	Valve	Lam	PPM		(11-99-9)	Concrete	CSST	40-10	CH4 (0-4)	
	Atmosphere	Meter	Sand			(100-339)	Stewalk	PVCB	100-120		
Leak Cause	Complete/Explanation	Material	System	Material	Leakage	Repair Date					
Corrosion	Pipe	Transmission	Steel				Rust/oxid		1-5	Barc	
Outside Ferric	Valve	Misa	Cur Line				Rural		5-Crater	Card	
Caust/Deterf	Filing	Service	Durable Iron				Commercial				
Material Defect	Regulator	Meter Set	Copper				Industrial				
Other	Tap Connection	Customer Pipe	Plastic								

#1 Riser	#2 HP Cock	#3 Regulator
#4 LP Cock	#5 Inlet Loop	#6 Inlet Capswivel
#7 Out Capswivel	#8 Outlet Loop	#9 Fuel Line Fitting
#10 Gas Meter	#11 Inlet	#12 Fuel Line



Address: 508 N Main Street City/County: Tompkinsville State: KY

25/8/13

Category #	Classification	Grade 1	Grade 2	Grade 3	Grade 4
1					
2					
3					

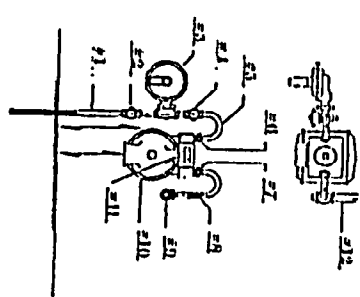

LEAK TOP OF LOCK VALVE  
AND TOP OF REGULATOR

Device	Location	Material	Spec	Pressure	Service	Material	Dimension	Notes
Mobile FI	Inlet Bulb	Metal		(0-1)	Gas	Steel	5-10	
Flame Psk	Outlet Side	Service		(1-20)	Dirt	PE	20-18	
Visual	Manhole	Top		(01-40)	Asphalt	Culvert	30-40	
CG/EC/D	Underground	Valve		(61-95.5)	Concrete	CSST	40-40	
Search	Atmosphere	Meter		(100-329)	Sidewalk	PVC	10.0-12.0	

Address: White ST NEAR House 514

City: County:

Tompkins, Me

State: KY



2" GAS MAIN N  
 GAS 8' LEAD WATER METER N  
 HOUSE 514

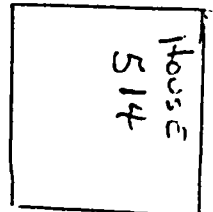

White Street

Material	Quantity	Notes
Gas Main	2"	N
Gas Lead	8'	Water Meter N
Water Meter	1	N
Gas Meter	1	N
House	514	

Material	Quantity	Notes
Gas Main	2"	N
Gas Lead	8'	Water Meter N
Water Meter	1	N
Gas Meter	1	N
House	514	

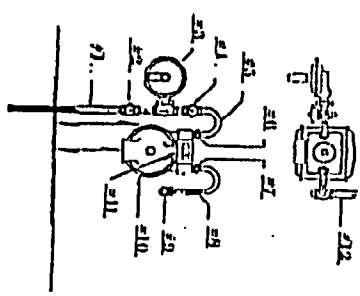

Material	Quantity	Notes
Gas Main	2"	N
Gas Lead	8'	Water Meter N
Water Meter	1	N
Gas Meter	1	N
House	514	





Address: 701 Mooree Drive City/County: Temp Kinsville State: KY Date: 28/8/13

IN Ground LEAK AT RISER

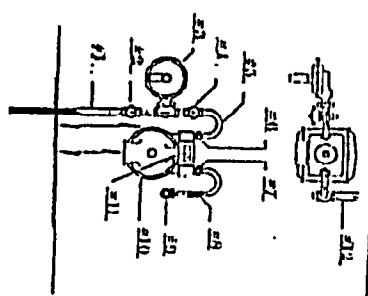

#1 Regulator	#2 HP Cock	#3 Regulator
#4 LP Cock	#5 Inlet Loop	#6 Inlet Cap/Swivel
#7 Out Cap/Swivel	#8 Outlet Loop	#9 Fuel Line Fitting
#10 Gas Bleeder	#11 Inlet	#12 Fuel Line

Defect	Location	Material	CG/CE/CP	Size	Material	Notes
Mobile FI	Inside Bldg	None		(0-1)	Grass	Soil
Flame Park	Outside Bldg	Service		(1-3/8)	Dirt	PE
Valve	Manhole	Trap		(1-40)	Asphalt	Cast Iron
CG/CE/CD	Underground	Valve		(1-1/2-3/4)	Concrete	CSST
Soil	Atmosphere	Meter		(100-3/8)	Sidewalk	IVCB
Corrosion	Pipe	Transmission			Roadside	1-5
Outside Force	Valve	Main			Rural	S-Creaser
Cap/Duct	Fitting	Service			Commercial	Date Reported:
Material Defect	Regulator	Miter Set			Industrial	Date Rechecked:
Other	Tap Connection	Customer Pipe				

## VISUAL INSPECTION OF MAINS AND SERVICE PIPELINES

Address: 503 Old Glasgow Rd Location: Main is on Northside of Hwy 63.

TYPE	CONDITION	CORROSION	COATING TYPE
Steel	✓ Excellent	✓ Localized	Millwrap ✓
PE	Good	General	Enamel
Cast Iron	Slight Pitting	Other	✓ Roskote
CSST	Extreme Pitting	Pitting Depth	Oxidemp
Main	Hole/Voids		Xtruecoat
Service	Graphitization		Mastic
Other	Bent		Cold Roll
	Broken		Hot Wrap
	Other		Heat Shrink
COATING CONDITION	SOIL TYPE	SOIL COMPOSITION	EXCAVATION
Good	✓ Rock	Dry	Main Extension
Poor	Cinder	Wet/Swampy	Service Tap
Damaged	Clay	✓ Normal	✓ Leak Repair ✓ on farm Tap.
Other	Loam	Moister Range (3-5)	Re-routing
	Sand	Moister Range (5-8)	Third Party
	Alluvion		Abandonment
	Other		Deactivation
			Utility Theft
			Other

Description/Comments:

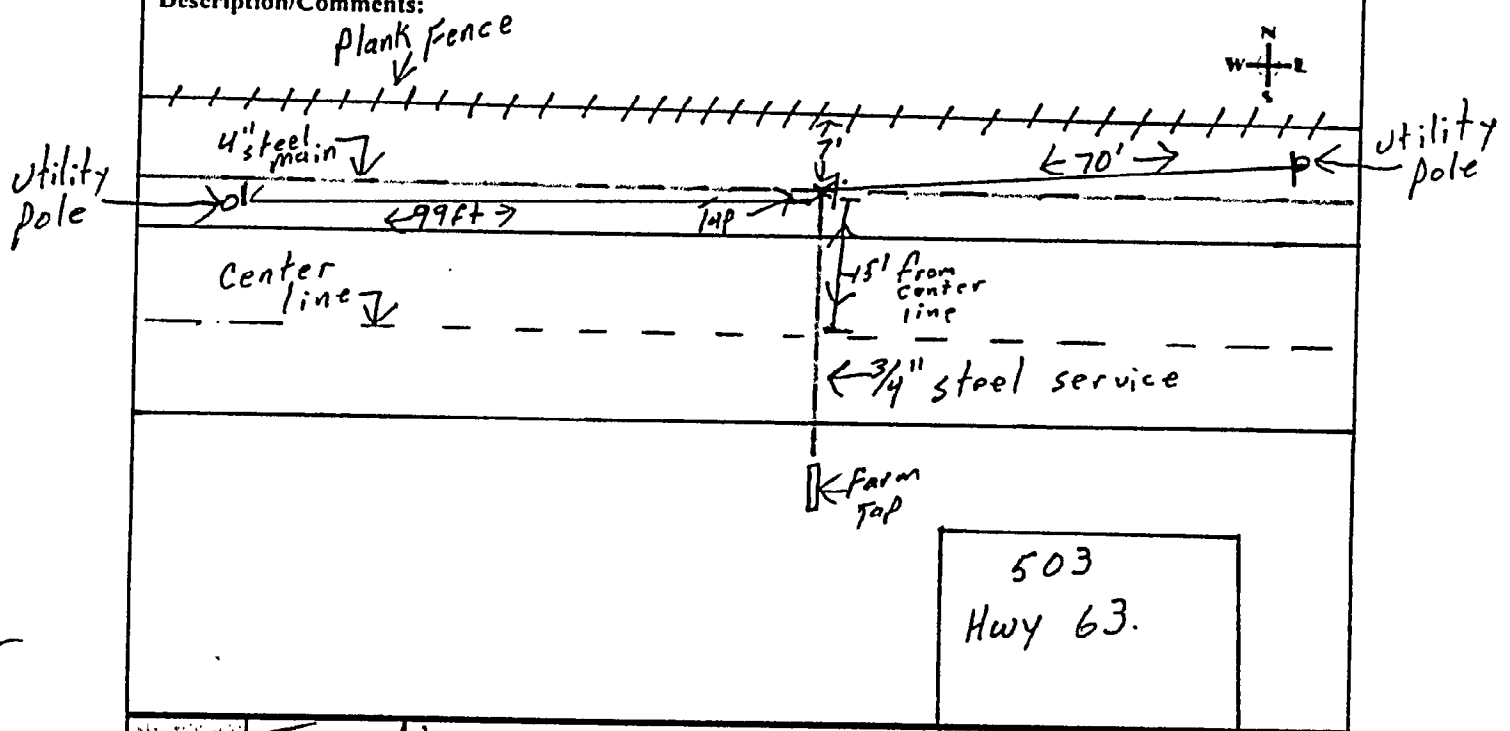

Name: Jason Warren Date: 9-13-13

Visual Main Inspection

Address 503 Old Glasgow Rd.

City/Township Tompkinsville / Monroe

State KY



Date 9-10-13

Case #	Grade 1	Grade 2	Grade 3
Classification			
Meter #			
Manufacturer #			
	Inside		
	Outside		

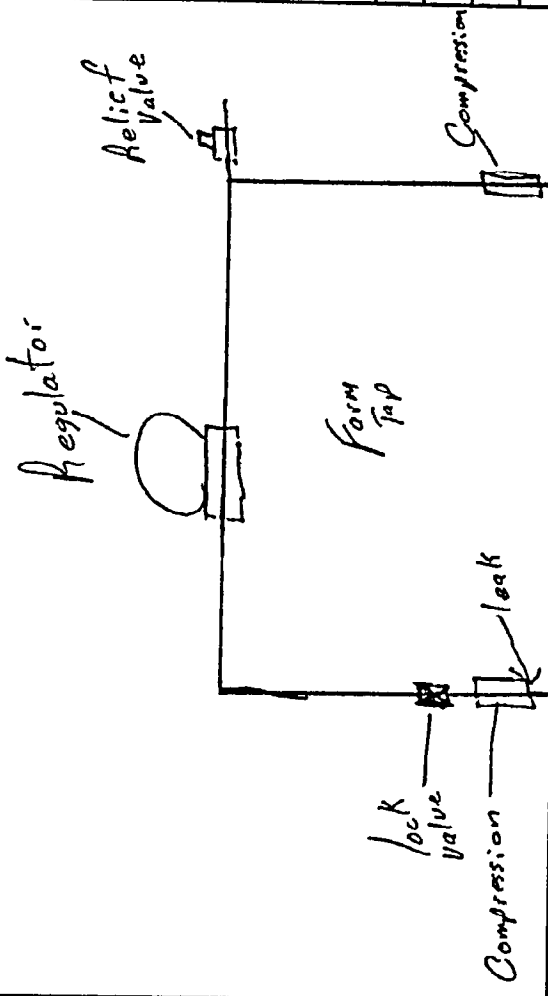
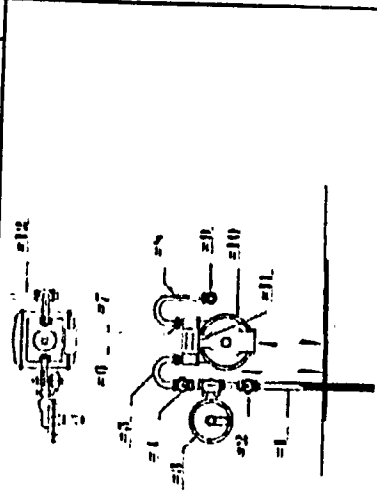

#1 Riser	#2 HP Cock	#3 Regulator
#4 LP Cock	#5 Inlet Loop	#6 Inlet Cap/Swivel
#7 Out Cap/Swivel	#8 Outlet Loop	#9 Fuel Line Fitting
#10 Gas Meter	#11 Index	#12 Fuel Line

Detection	Location	Soil Sub	CG/EGD	Pressure	Surface	Pipe	Size	Weather
Mobile FT	Main	Rock	% Gas	(0-1)	Grass	Steel	5-2.0	Clear
Flame Pack	Service	Cinder	LEL	(1-30)	Dirt	PE	2.0-3.0	Wet
Visual	Tap	Clay	UEL	(31-40)	Asphalt	Cast Iron	3.0-4.0	Hot (125-100)
CG/EGD	Undergrad	Loam	PPM	(61-99.9)	Concrete	CSST	6.0-8.0	Cold (0-40)
Smell	Atmosphere	Sand		(100-399)	Sidewalk	PVCB	10.0-12.0	

Leak Cause	Component/Explanation	Part of System	Type Material	Location Area	Repair Data
Corrosion	Pipe	Transmission	Steel	Residential	1-5
Outside Force	Valve	Main	Cast Iron	Rural	5-Greater
Const/Defect	Fitting	Service	Ductile Iron	Commercial	Date Required:
Material Defect	Regulator	Meter Ser	Copper	Industrial	Date Rechecked:
Other	Tap Connection	Customer Pipe	Plastic		

Leak called in by customer.  
 Repaired 9-13-13

Address 503 Old Glasgow Rd

City/Township Tompkinsville

State KY

Date 9-13-13

Case #	Grade 1	Grade 2	Grade 3
Classification			
Meter #			Inside
Manufacturer #			Outside

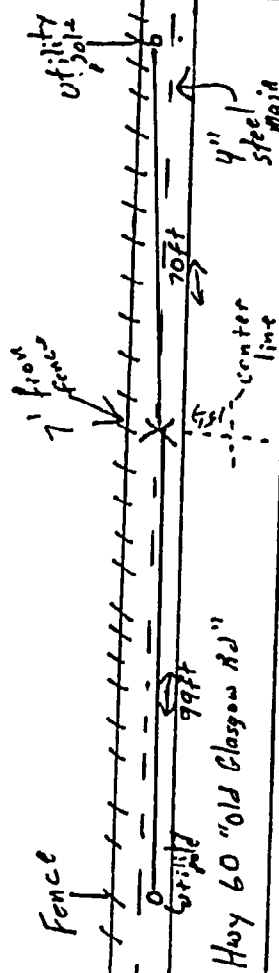
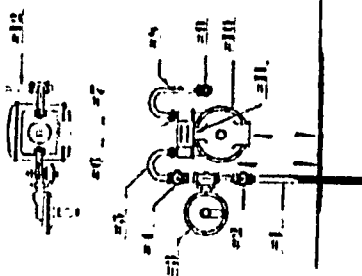

Detection	Location		Soil Sub	CGI/EGB	Pressure	Pipe		Weather
	Inside Bldg	Main				Surface	Size	
Mobile Ft		Main	Rock	% Gas	(0-1)	Steel	5-2.0	Clear
Flame Pack	Outside Bldg	Service	Clay	LEL	(1-30)	PE	2.0-3.0	Wet
Visual	Manhole	Tap	Clay	UEL	(31-60)	Cast Iron	3.0-4.0	Hot (85-100)
CGI/EGB	Undergrad	Valve	Loam	PPM	(61-99.9)	CSST	4.0-8.0	Cold (0-40)
Smell	Atmosphere	Meter	Sand		(100-399)	PVCB	10.0-12.0	
Leak Cause	Component/Explanation		Part of System		Type Material	Location Area		Repair Data
Corrosion	Pipe		Transmission		Steel		Residential	1-5
Outside Ferric	Valve		Main		Cast Iron		Rural	5-Greater
Consu/Defect	Fitting		Service		Ductile Iron		Commercial	Date Repaired:
Material Defect	Regulator		Meter Set		Copper		Industrial	Date Rechecked:
Other	Tap Connection		Customer Pipe		Plastic			

"Reference Only" Gas tap at residence



109 S. Main St.

No leak found/Repaired

Monroe / Tompkinsville

KY

8-15-13

We tested the meter set r couldn't find a sign of a leak. We will keep monitoring the service for signs of a leak.

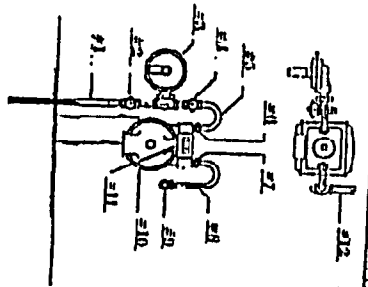

Material	Latex BWP	Nitrile	Butyl	% Cu	Grain	Steel	Galv
Malleable FT	<input checked="" type="checkbox"/>	<input checked="" type="checkbox"/>	<input checked="" type="checkbox"/>				
Therm Pack	<input checked="" type="checkbox"/>	<input checked="" type="checkbox"/>	<input checked="" type="checkbox"/>				
Vessal	Misshape	Top	Clay	UTL	Dir	PE	28-110
CGUCGD	Undergrad	Valve	Lanes	PPM	Asphalt	Car Line	10-48
Sealt	Amosphere	Miter	Sand		Cement	CST	6-110
Leak Gauge	Compen/E				Siderwalk	PVC	16-110
Corrosion	Type	Transmission	Steel	Ratidnial	LS	Bar	
Outside Force	Value	Main	Car Line	Rural	5-Creter	Card	
Caust/Duct	Fitting	Service	Dumbc Iron	Commercial	Date Repair:	8-16-13	
Material Defect	Regulator	Meter Set	Copper	Industrial	Date Recheck:		
Other	Tap Connections	Customer Type	Plastic				



Address: 105 S Magnolia St. City/County: Tompkinsville Monroe KY 8-15-13

Repaired

The service at this address was not in use, & hadn't been for some time. We removed all above ground fittings down to the lock valve & put a plug in the top for future use at the home if needed.

Material Defect	Location	Material	Quantity	Notes
Mobile TI	Inside Bldg	Black	(0-1)	
Flame Park	Outside Bldg	Cast Iron	(1-30)	
Valve	Misable	Clay	(1-40)	
CGI/CO	Underground	WFL	(1-50)	
Sanit	Atmosphere	WFL	(1-50)	
Corrosion	Pipe	Lead	(100-300)	
Outside Force	Valve	Cast Iron		
Cast/Defect	Fitting	Ductile Iron		
Material Defect	Regulator	Meter Set		
Other	Tap Connections	Customer Pipe		

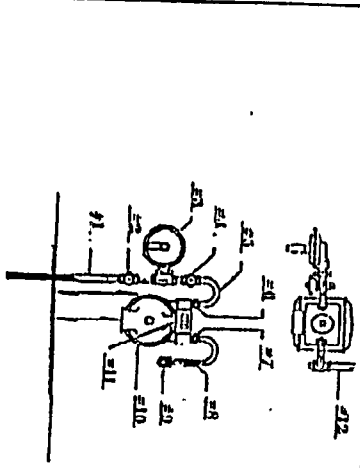

Material	Quantity	Notes
#1 Meter		
#2 HP Cast		
#3 Inlet Loop		
#4 Outlet Loop		
#5 Fuel Line Fitting		
#6 Inlet		
#7 Outlet		
#8 Vent		
#9 Vent Pipe		
#10 Vent Cap		
#11 Vent Pipe		
#12 Vent Cap		

Date Repaired: 8-16-13

308 5th Street  
 Tompkinsville / Monroe  
 KY  
 8-27-8

Repaired

Broke down the meter set to the lock valve  
 r redoped the service. We also replaced the  
 regulator We then rebuilt the meter set &  
 checked for leaks.

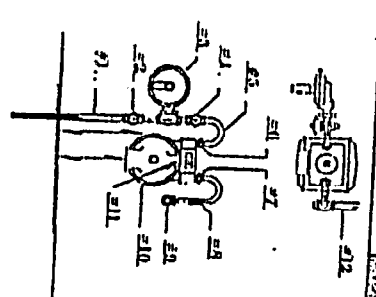

Material	Location	Soil	CO/EPD	Grade	Surfactant	Material	Grade	Surfactant	Material	Grade	Surfactant
Mastic FI	Inlet Bldg	Mina	Back	% Gas	(b-1)	Grass	Steel	5-20	Clear		
Flame Pack	Outlet Bldg	Service	Center	LEL	(1-30)	Dirt	PE	2.8-1.0	Wtr		
Vessel	Masonry	Top	Clay	UEL	D1-40)	Asphalt	Cur/Lime	3.8-4.8	Hdr (25-100)		
CG/EGD	Undergrad	Valve	Lamin	PPM	(41-39.9)	Concrete	CSST	6.4-1.0	Cell (0-4)		
Seals	Atmosphere	Meter	Sand		(100-39.9)	Sidewalk	PVCB	10.0-12.8			
Corrosion	Flt	Transmission	Steel			Railroad					
Outside Force	Valve	Mina	Cur/Lime			Rural					
Construction	Fitting	Service	Ductile Iron			Commercial					
Material Defect	Regulator	Meter Set	Copper			Industrial					
Other	Tap Connections	Customer Pipe	Plastic								

#1 Riser	#2 LP Cook	#3 Regulator
#4 LP Cook	#5 Inlet Loop	#6 Inlet Cap/Swivel
#7 Out Cap/Swivel	#8 Outlet Loop	#9 Fuel Line Fitting
#10 Gas Meter	#11 Inlet	#12 Fuel Line

Date Replaced: 8-29-13  
 Date Rechecked:



103 S. Magnolia St.  
 Tompkinsville / Monroe  
 KY  
 8-29-13

Repaired

Lock valve was leaking through on an old service with no meter. We broke down the service & replaced the faulty lock valve. We then locked off the service & tested for leaks.

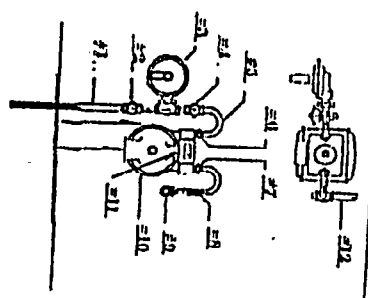

#1 Meter	#2 HP Cook	#3 Regulator
#4 LP Cook	#5 Inlet Loop	#6 Inlet CapSwivel
#7 Out CapSwivel	#8 Outlet Loop	#9 Fuel Line Fitting
#10 Gas Meter	#11 Index	#12 Fuel Line

Material	Grade	Size	Length	Weight	Notes
Male FI	Cast Iron	1/2"	6'-0"	1.30	Steel
Female FI	Cast Iron	1/2"	6'-0"	1.30	PE
Flange Pack	Cast Iron	1/2"	20.18	1.0	W/d
Weld	Cast Iron	1/2"	1.0	1.0	Md (RS-10)
CC/EGD	Cast Iron	1/2"	4.44	0.4	CD (0-4)
Seat	Cast Iron	1/2"	10.42	0.8	
Corrosion	Steel	1/2"			
Outside Force	Cast Iron	1/2"			
Cast/Defect	Cast Iron	1/2"			
Material Defect	Cast Iron	1/2"			
Other	Cast Iron	1/2"			





500 5th Street

Repaired

City/County

Tompkinsville / Monroe

KY

8-29-13

Replaced 3/4" lock valve + 3 inch nipple.  
 Broke down service, replaced the lock valve + a  
 3" nipple. Rebuilt meter set + soap tested.

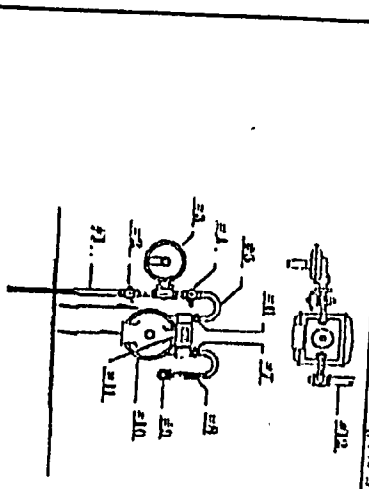

Material	Location	Notes	Quantity	Unit	Price	Total
Mobile FI	Inside Bldg	Nipple	1	ft	1.10	1.10
Team Park	Outside Bldg	Service	1	hr	28.39	28.39
Yeast	Plastic	Tap	1	ea	3.00	3.00
COUCD	Underground	Valve	1	ea	6.99	6.99
Small	Atmosphere	Meter	1	ea	140.12	140.12
Gas	Transmission	Steel	1	ft	1.10	1.10
Outlet Force	Valve	Male	1	ea	1.10	1.10
Countdown	Fitting	Service	1	hr	28.39	28.39
Material Defect	Regulator	Meter Set	1	ea	6.99	6.99
Other	Tap Connections	Customer Pipe	1	ft	1.10	1.10

Date Reported: 8-29-13

Date Rechecked:

Repaired from leak survey in town.

Address: 408 6th Street City: Tompkinsville / Monroe State: KY Date: 9-4-13

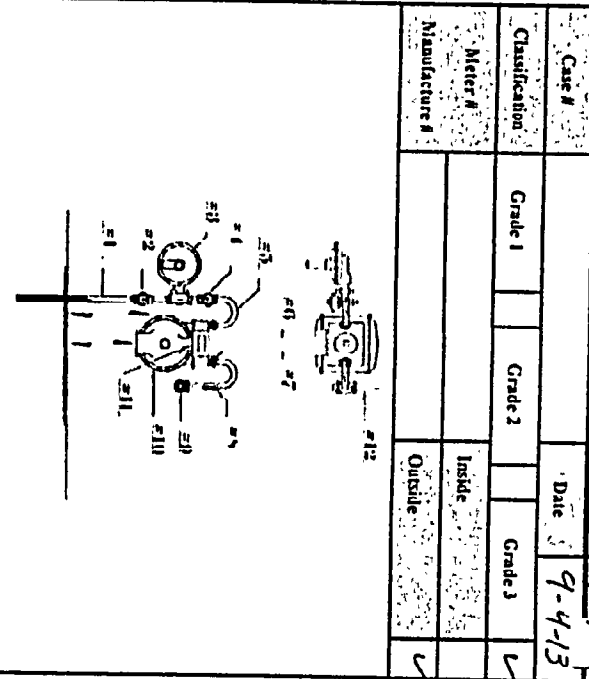
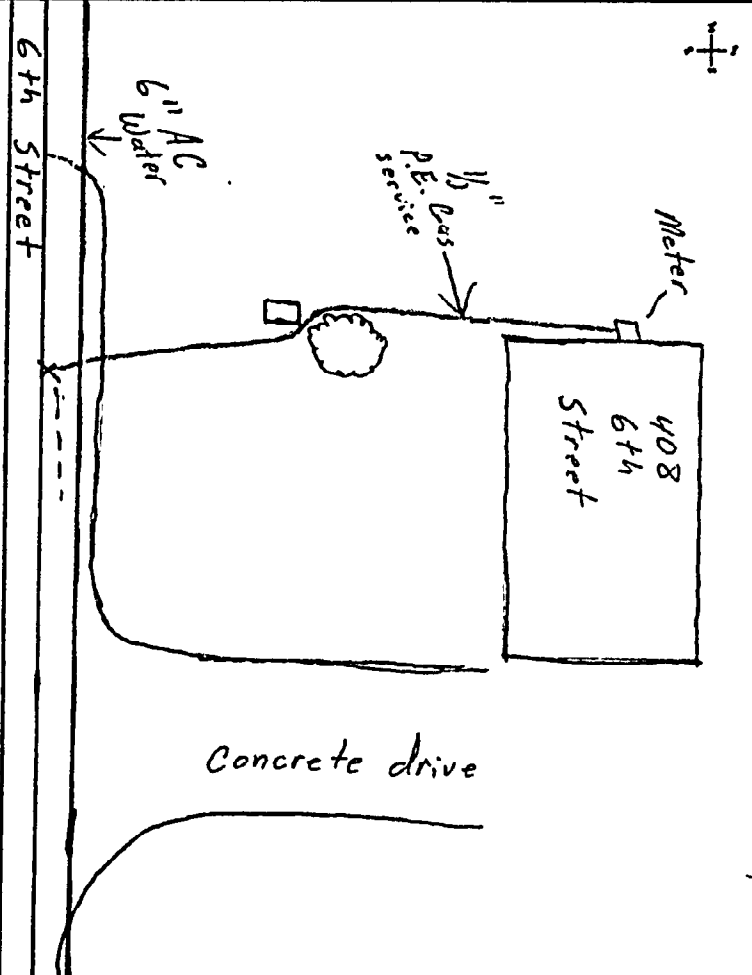

Detection		Location		Soil Sub		CG/EGD		Pressure		Surface		Pipe		Size		Material					
Mobility FI	✓	Inside Bldg	Main	Rock		% Gas	20	(0-1)		Grass	Steel	5-10	Char								
Flame Pack	✓	Outside Bldg	Service	Cinder		LEL		(1-30)		Dirt	PE	20-10	Wt								
Visual	✓	Manhole	Tap	Clay		UEL		(31-40)	✓	Asphalt	Cast Iron	30-10	Hot (85-100)								
CG/EGD	✓	Underground	Yoke	Loam		PPM		(61-99.9)	✓	Concrete	CSST	60-10	Cold (0-40)								
Sand	✓	Atmosphere	Meter	Sand				(100-399)		Sidewalk	PVCB	100-120									
Leak Cause		Component/Explanation				Part of System				Type Material				Location Area				Repair Data			
Corrosion		Pipe		Transition		Steel			✓	Residential		1-5	Bare								
Outside Farc		Yoke		Main		Cast Iron				Rural		5-Grater	Coated								
Cons/Defect		Fitting	✓	Service		Ductile Iron				Commercial											
Material Defect	✓	Regulator		Meter Set		Copper				Industrial											
Other		Tap Connection		Customer Pipe		Plastic															

Leak found on compression tee. We cut it out + fused a PE tee back in place.

Date Rechecked: 9-12-13

134 Castle Heights Dr

Memphisville / Monroe

KY  
9-30-13

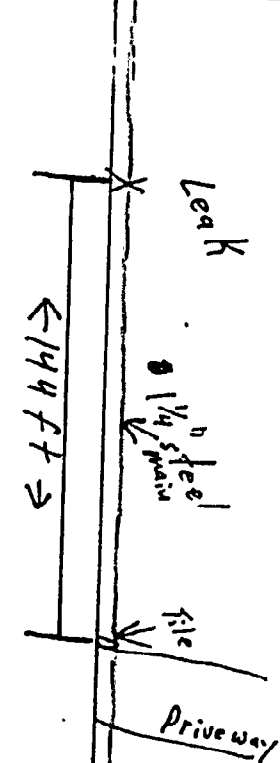

Castle Heights Dr.

134 Castle Heights

Material	Inside Mfg	Make	Back	% Gas	Size	Grade	Material	Year	Color	Notes
Malleable FT	Inside Mfg	Malle	Back	35	(6-1)	Steel	Steel	5-28	Dark	
Flange Pack	Outlet Bldg	Service	Center	LEI	(1-30)	Dkt	PE	2A-11	Wd	
Valve	Manhole	Ty	Qty	UEL	(11-60)	Alphak	Cast Iron	2A-4A		
CGUECD	Underground	Valve	Luan	PTM	(11-55-3)	Genome	CSST	4A-1A		
Small	Absorbers	Miter	Sand		(100-33)	Siderack	PVC	18A-11B		
Ceramic	Type	Transmission	Steel			Residential		1-5	Bar	
Outlet Fere	Valve	Mite	Cast Iron			Rural		5-Creiner	Card	
Caustic	Filling	Service	Duct Iron			Commercial				
Material Defect	Regulator	Miter Set	Copper			Industrial				
Other	Tap Connection	Customer Pipe	Plastic							

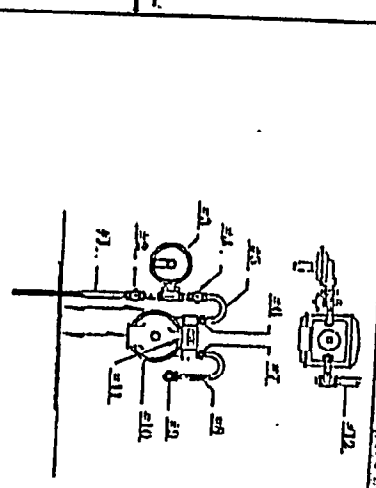

Leak reported by customer & repaired.

Address: 208 Rose Hill

City/Township: Tompkinsville / Monroe

State: KY

8-27-13



No leak found. Cleared.

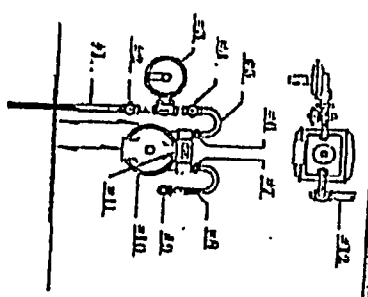

Location	Material	Size	Condition	Notes
Flame Pack	Cast Iron	4" dia	Good	
Visual	Malleable	1/2"	Good	
CO/UCD	Underground	1/2"	Good	
Sour	Acetylene	1/2"	Good	
Cerulium	Iron	1/2"	Good	
Outlet Fitter	Valve	1/2"	Good	
Couplings	Fitting	1/2"	Good	
Material Dates	Regulator	1/2"	Good	
Other	Tap Connection	1/2"	Good	

Leak repaired from survey.

Mai Adams

Address: 621 Springs Street. City: Tompkinsville / Menoer State: KY Date: 8-21-13

Leak was on the bottom of the regulator we broke down the service + redoped the leaking fittings. We then rebuilt it + tested for leaks.

Case #	Grade 1	Grade 2	Grade 3
Classification			
Meter #	Inside		
Manufacturer #	Outside		

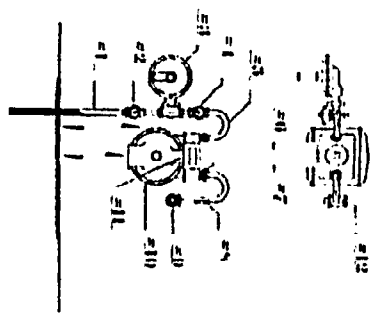

#1 Riser	#2 IIP Cock	#3 Regulator
#4 LP Cock	#5 Inlet Loop	#6 Inlet Capswivel
#7 Out Capswivel	#8 Outlet Loop	#9 Fuel Line Fitting
#10 Gas Meter	#11 Index	#12 Fuel Line

Detection	Location	Soil Sub	CGUEGD	Pressure	Surface	Pipe	Size	Weather
Mobik FI	Inside Bldg	Main		(0-1)	Grass	Steel	5-10	Clear
Flame Pack	Outside/Bldg	Service		(1-30)	Dirt	PE	20-30	Wh
Visual	Mainhole	Trap		(31-40)	Asphalt	Cast Iron	3.0-4.0	Hot (85-100)
CGUEGD	Underground	Valve		(41-99.9)	Coconete	CSST	6.0-8.0	Cold (0-40)
Small	Atmosphere	Meter		(100-399)	Sidewalk	PVCB	10.0-12.0	

Leak Cause	Component/Explanation	Part of System	Type Material	Location Area	Repair Data
Corrosion	Pipe	Transmission	Steel	Residential	1-5 Bar
Outside Force	Valve	Main	Cast Iron	Rural	S-Creaser Coiled
Construction	Fitting	Service	Ductile Iron	Commercial	Date Repaired: 9-26-13
Material Defect	Regular	Meter Set	Copper	Industrial	Date Rechecked:
Other	Tap Connection	Customer Pipe	Plastic		

Leak repaired from survey of Mai Chohan

*Mai Chohan*



Address: 101 Celina Rd. City: Tompkinsville / Monroe State: KY

The leak was on the bottom of the regulator. We broke down the service, redepiped the fitting + rebuilt the loop. We then tested for leaks.

Case #	Grade 1	Grade 2	Grade 3	Date
Classification				8-21-13
Meter #	Inside			
Manufacturer #	Onsite			

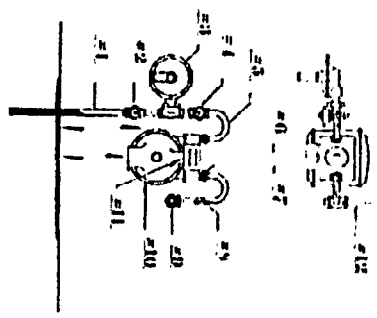

#1 Riser	#2 H.P. Cock	#3 Regulator
#4 LP Cock	#5 Inlet Loop	#6 Inlet Capswivel
#7 Out Capswivel	#8 Outlet Loop	#9 Fuel Line Fitting
#10 Gas Meter	#11 Index	#12 Fuel Line

Detection	Location	Soil Sub	CGI/GCD	Pressure	Surface	Pipe	Size	Weather
Mobile Ft	Inside Bldg	Rock	(0-1)		Grass	Steel	5-10	Clear
Flame Pack	Outside Bldg	Clay	LEL	(1-30)	Dirt	PE	2.0-3.0	Wet
Visual	Manhole	Clay	UEL	(31-40)	Asphalt	Cast Iron	3.0-4.0	Hot (85-100)
CGI/GCD	Underground	Loam	PPM	(41-99.9)	Concrete	CSST	6.0-8.0	Cold (0-40)
Sand	Atmosphere	Sand		(100-399)	Sidewalk	PVCB	10.0-12.0	

  

Leak Cause	Component/Explanation	Part of System	Type Material	Location Area	Repair Data
Corrosion	Pipe	Transmission	Steel	Residential	1-5
Outlet Fitting	Valve	Main	Cast Iron	Rural	5-Creaser
Caustic Defect	Fitting	Service	Ductile Iron	Commercial	Cauld
Material Defect	Regulator	Meter Set	Copper	Industrial	Date Replaced: 9-26-13
Other	Tap Connection	Customer Pipe	Paint		Date Replaced:

Leak repaired from survey

Leak on the bottom of the regulator.  
 We broke the loop down, redoped the fittings, + rebuilt the loop. We then tested for leaks.

Case #	Grade 1	Grade 2	Grade 3
Classification			
Meter #	Inside		
Manufacturer #	Outside		

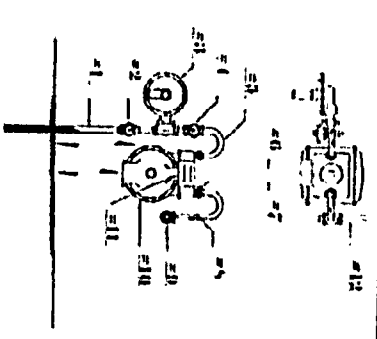

Detection	Location	Soil Sub.	CG/EG/CD	Pressure	Surface	Pipe	Size	Weather
Mobile FI	Inside Bldg	Rock	% Gas	(0-1)	Grass	Steel	5-2.0	Clear
Flame Patch	Outside Bldg	Clinder	LEL	(1-30)	Dirt	PE	2.0-3.0	Wet
Visual	Manhole	Clay	UEL	(31-60)	Asphalt	Cast Iron	3.0-4.0	1161 (85-100)
CG/EG/CD	Undergrad	Loam	PPM	(61-99.9)	Concrete	CST	6.0-8.0	Coil (0-40)
Sneel	Atmosphere	Sand		(100-399)	Sidewalk	PVCB	10.0-12.0	

Leak Cause	Component/Explanation	Part of System	Type Material	Location Area	Repair Data
Corrosion	Pipe	Transmission	Steel	Residential	1-5
Outside Ferris	Valve	Main	Cast Iron	Rural	5-Greater
Canu/Detect	Fitting	Service	Ductile Iron	Commercial	Coiled
Material Detect	Regulator	Meter Set	Copper	Industrial	Date Replaced: 9-26-13
Other	Tap Connection	Customer Pipe	Plastic		Date Replaced:

Leak repaired from survey

Wai Abd

Christ the King Church, Celina Rd, Clay City, Mo, Tomkinsville / Monroe, State KY

Case #	Grade 1	Grade 2	Grade 3
Classification			
Meter #	Inside		
Manufacturer #	Outside		

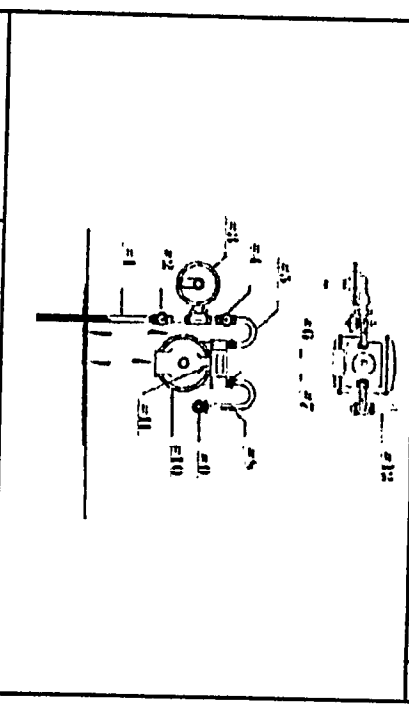

Broke down meter loop & redoped the fittings. We then rebuilt it & tested for leaks

Detection	Location	Soil Sub	CGI/EGD	Pressure	Surface	Pipe	Size	Weather
Mobile FI	Inside Bldg	Main		(0-1)	Grass	Steel	5-2.0	Clear
Flame Pack	Outside Bldg	Service		(1-30)	Dirt	PE	2.0-1.0	Wet
Visual	Manhole	Tap		(31-60)	Asphalt	Cast Iron	3.0-1.0	Hot (85-100)
CGI/EGD	Underground	Valve		(61-99.9)	Concrete	CSST	6.0-4.0	Cold (0-40)
Safer	Atmosphere	Meter		(100-399)	Sidewalk	PVCB	10.0-12.0	

Leak Cause	Component/Explanation	Part of System	Type Material	Location Area	Repair Date
Corrosion	Pipe	Transmission	Steel	Residential	1-5
Outside Force	Valve	Main	Cast Iron	Rural	5-Greater
Crack/Defect	Fitting	Service	Ductile Iron	Commercial	Date Repaired: 9-26-13
Material Defect	Regulator	Meter Set	Copper	Industrial	Date Rechecked:
Other	Tap Connection	Customer Pipe	Plastic		

Leak repaired from survey

*Mas Osh*





Address 501 5TH ST.

City/Town/Twp Tompkinsville Monroe State KY

Case #	Grade 1	Grade 2	Grade 3
Classification			
Meter #	Inside		
Manufacturer #	Outside		

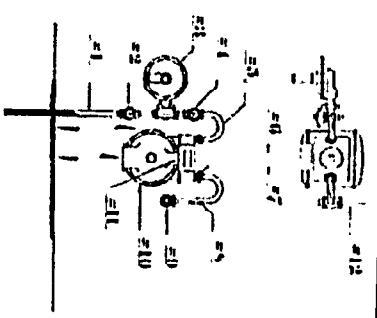

#1 Riser	#2 IIP Cock	#3 Regulator
#4 LP Cock	#5 Inlet Loop	#6 Inlet Cap/Swivel
#7 Out Cap/Swivel	#8 Outlet Loop	#9 Fuel Line Fitting
#10 Gas Meter	#11 Index	#12 Fuel Line

No leak found.

Detection	Location	Soil Sub	CGI/GCD	Pressure	Surface	Type	Size	Weather			
Mobile FI	Inside Bldg	Rock	(0-1)		Grass	Steel	5-10	Clear			
Flame Pack	Outside Bldg	Gravel	LEL	(1-30)	Dirt	FE	2.0-3.0	Wet			
Visual	Manhole	Clay	UEL	(31-40)	Asphalt	Cast Iron	3.0-4.0	Hot (85-100)			
CGI/GCD	Undergrad	Loam	PFM	(61-99.9)	Concrete	CSST	6.0-8.0	Cold (0-40)			
Small	Atmosphere	Sand		(100-399)	Sidewalk	PVCB	10.0-12.0				
Leak Cause		Component/Explanation		Part of System		Type Material		Location Area		Repair Data	
Corrosion	Pipe	Transmission	Steel		Residential		1-5	Bare			
Outside Force	Valve	Main	Cast Iron		Rural		5-Creater	Coupled			
Cont/Defect	Fitting	Service	Ductile Iron		Commercial		Date Repaired: 9-16-13				
Material Defect	Regulator	Meter Set	Copper		Industrial		Date Rechecked:				
Other	Tap Connection	Customer Pipe	Plastic								

Leak repaired from survey.

Mai Ock



668 Spring Street

Tompkinsville / Monroe

KY

9-26-13

We broke down the meter set + rebuilt it. We redoped every fitting when putting it back together. We then tested for leaks.

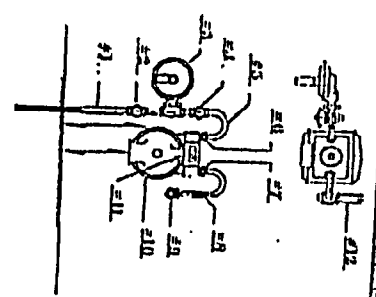

#1 Meter	#2 IIP Cock	#3 Regulator
#4 IP Cock	#5 Inlet Loop	#6 Inlet Capswired
#7 Out Capswired	#8 Outlet Loop	#9 Fuel Line Fitting
#10 Gas Meter	#11 Index	#12 Fuel Line

Material	Insulation	Notes	Grade	Depth	Material	Notes	Grade	Depth
Public FI	Insulate Bldg	None	None	(1-1)	Grass	Steel	5-12	Clay
Flame Park	Outstanding	Service	Outlet	(1-10)	Dirt	PE	24-10	YH
Visual	Mechanic	Tap	Clay	(1-40)	Asphalt	Cast Iron	30-48	Hit (65100)
CGI/CD	Underground	Valve	Lum	(1-51.5)	Concrete	CSST	48-11	Cast (0-1)
Small	Atmosphere	Meter	Sand	(100-119)	Siltsand	PVC	160-114	
Corrosion	✓ Pipe		Transmission		Residential	Steel	15	Bar
Outside Force	Valve		None		Rural	Cast Iron	5-Gravel	Cast
Cast/Duct	Fitting		Service		Commercial	Ductile Iron		
Material Defect	Regulator		Meter Set		Industrial	Copper	Date Reported: 9-26-13	
Other	Tap Connects		Customer Pipe			Plastic	Date Rechecked:	

Leak repaired from leak survey

*Wai Weber*

Address: **Castle Heights Rd + Emerton St** | City: **Monroe** | State: **KY**  
 Zip: **40383**

Found leak on 1/2" line.  
 A weld was leaking from corrosion.  
 We put a repair clamp on to temporarily repair it.

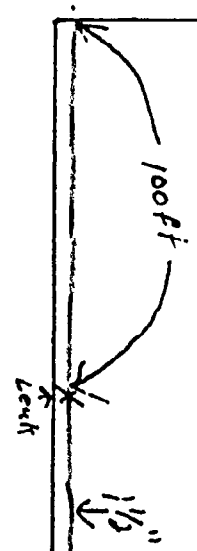

Castle Heights Rd

Mobile Home

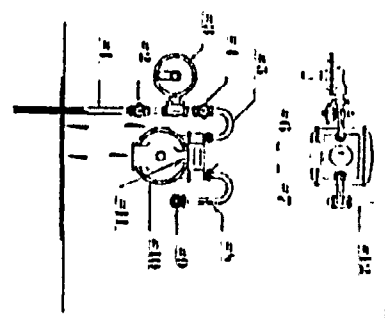

Case #	Grade 1	Grade 2	Grade 3	Date
				9-30-13
Classification	Grade 1	Grade 2	Grade 3	
Meter #				
Manufacturer #				
Location Area	Residential	Commercial	Industrial	
Repair Data	1-5	5-Creater	Bar	Coiled
Date Reported:	9-30-13			
Date Rechecked:				

Detection	Location	Soil Sub	CG/EGD	Pressure	Surface	Pipe	Size	Weather	
Flame Pack	Inside Bldg	Rock		(P-1)	Grass	Steel	5-10	Clear	
Visual	Outside/Bldg	Clay	LEL	(1-30)	DIRT	PE	2.0-3.0	Wet	
CG/EGD	Manhole	Clay	UEL	(31-40)	Asphalt	Cast Iron	3.0-4.0	Hot (95-100)	
Small	Underground	Lamin	PMI	(41-99.9)	Concrete	CSST	6.0-8.0	Cold (0-40)	
	Atmosphere	Sand		(100-999)	Sidewalk	PVCB	10.0-12.0		
Leak Cause		Component/Explanation		Part of System		Type Material		Location Area	
Corrosion	Pipe	Transmission	Steel	Residential	1-5	Bar			
Outside Fault	Valve	Main	Cast Iron	Rural	5-Creater	Coiled			
Cont/Defect	Fitting	Service	Ductile Iron	Commercial	Date Reported:	9-30-13			
Material Defect	Regulator	Meter Set	Copper	Industrial	Date Rechecked:				
Other	Tap Connection	Customer Pipe	Plastic						

Leak repaired from leak survey  
 Repaired by Carey

Regulator was believed to be venting off at this location. We rechecked the area & found nothing. Area clear.

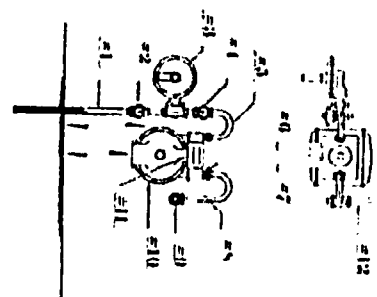

Leak Cause		Component/Explanation		Part of System		Type Material		Location Area		Repair Data	
Detection	Location	Soil Sub.	CGI/EGD	Pressure	Surface	Pipe	Size	Weather			
None FI	Inside Bldg	Main			Grass	Steel	5-2.0	Clear			
Flame Path	Outside Bldg	Service	✓	(4-1)	Dirt	PE	2.0-3.0	Wet			
Visual	Manhole	Tap		(1-30)	Asphalt	Cast Iron	3.0-4.0	Hot (85-100)			
CGI/EGD	Underground	Valve		(31-40)	Concrete	CSST	4.0-4.0	Cold (0-10)			
Small	Atmosphere	Meter		(61-99.9)	Sidewalk	PVCB	10.0-12.0				
Corrosion	Pipe	Transmission		(100-399)							
Outside Force	Valve	Main			Residential		1-5	Bare			
Cond/Detect	Fitting	Service			Rural		Scrafter	Coated			
Material Detect	Regulator	Meter Set	✓		Commercial		Date Repaired:				
Other	Tap Connection	Customer Pipe			Industrial		Date Rechecked:				

Leak repaired from leak survey  
Repaired by Carry

9-30-13

We broke down the meter set & redoped the leaking fittings. We had to replace a 3" nipple also due to corrosion. We then rebuilt the set, checked for leaks, & relit the customer.

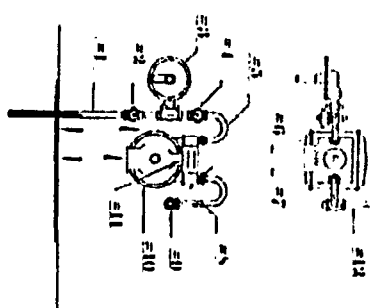

Detection	Location	Soil Sub.	CGI/EGD	Pressure	Surface	Pipe	Size	Weather	
Mobile FI	Inside Bldg	Main		(0-1)	Grass	Steel	5-2.0	Clear	
Flame Pack	Outside Bldg	Service	✓	(1-30)	Dirt	PE	2.0-3.0	Wet	
Visual	Mainhole	Top		(31-40)	Asphalt	Cast Iron	3.0-4.0	11a (GS-100)	
CGI/EGD	Underground	Valve		(41-99.9)	Concrete	CSST	6.0-8.0	Cold (0-40)	
Small	Atmosphere	Meter	✓	(100-199)	Sidewalk	PVCB	10.0-12.0		
Leak Cause		Component/Explanation		Part of System		Type Material		Location Area	
Corrosion	✓	Pipe	Transmission	Steel	Residential	✓	1-5	Bar	
Outside Force		Valve	Main	Cast Iron	Rural		5-Creater	Cold	
Coast/Defect		Fitting	Service	Ductile Iron	Commercial		Date Repaired: 10-1-13		
Material Defect		Regulator	Meter Set	Copper	Industrial		Date Rechecked:		
Other		Trap Connection	Customer Pipe	Plastic					

Leak repaired from leak survey. Repaired by Casey

Replaced the leak valve, a 4" 3/4 nipple, & replaced the regulator. We also repaired four small leaks on the meters set.

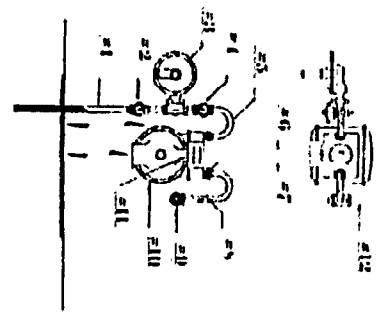

Detection	Location		Soil Sub	CGI/EGD	Pressure	CGI/EGD	Type Material	Surface		Pipe	Size	Weather																																				
	Inside Bldg	Main						Rock	% Gas				Grav	Seed																																		
Flame Pack	✓	Outside Bldg	✓	Service	✓	Cinder	LEL	(1-30)	✓	Dir	PE	2.0-3.0	Wet																																			
Visual		Main		Tap		Clay	UEL	(21-60)	✓	Asphalt	Cast Iron	3.0-4.0	Hot (85-100)																																			
CGI/EGD		Undergrad		Valve		Loam	PPM	(61-99.9)		Concrete	CST	6.0-8.0	Cold (0-40)																																			
Small		Atmosphere		Meter		Sand		(100-399)		Sidewalk	PVCB	10.0-12.0																																				
<table border="1"> <thead> <tr> <th>Corrosion</th> <th>Component/Explanation</th> <th>Part of System</th> <th>Type Material</th> <th>Location Area</th> <th>Repair Data</th> </tr> </thead> <tbody> <tr> <td>✓</td> <td>Pipe</td> <td>Transmission</td> <td>Steel</td> <td>Residential</td> <td>1-5</td> </tr> <tr> <td></td> <td>Valve</td> <td>Main</td> <td>Cast Iron</td> <td>Rural</td> <td>S-Greater</td> </tr> <tr> <td></td> <td>Fitting</td> <td>Service</td> <td>Ductile Iron</td> <td>Commercial</td> <td></td> </tr> <tr> <td></td> <td>Regulator</td> <td>Meter Set</td> <td>Copper</td> <td>Industrial</td> <td>Date Repaired: 10-1-13</td> </tr> <tr> <td></td> <td>Tap Connection</td> <td>Customer Pipe</td> <td>Plastic</td> <td></td> <td>Date Rechecked:</td> </tr> </tbody> </table>													Corrosion	Component/Explanation	Part of System	Type Material	Location Area	Repair Data	✓	Pipe	Transmission	Steel	Residential	1-5		Valve	Main	Cast Iron	Rural	S-Greater		Fitting	Service	Ductile Iron	Commercial			Regulator	Meter Set	Copper	Industrial	Date Repaired: 10-1-13		Tap Connection	Customer Pipe	Plastic		Date Rechecked:
Corrosion	Component/Explanation	Part of System	Type Material	Location Area	Repair Data																																											
✓	Pipe	Transmission	Steel	Residential	1-5																																											
	Valve	Main	Cast Iron	Rural	S-Greater																																											
	Fitting	Service	Ductile Iron	Commercial																																												
	Regulator	Meter Set	Copper	Industrial	Date Repaired: 10-1-13																																											
	Tap Connection	Customer Pipe	Plastic		Date Rechecked:																																											

Leak repaired from leak survey  
Repaired by Casey



Address: Sw & Paige Street.

City/Town: Tompkinsville

State: Ky

Case #	Grade 1	Grade 2	Grade 3
Classification			
Meter #	Inside		
Manufacturer #	Outside		

*Leak was on the lock valve. Broke down meter set & redeveloped all fittings to repair the leak.*

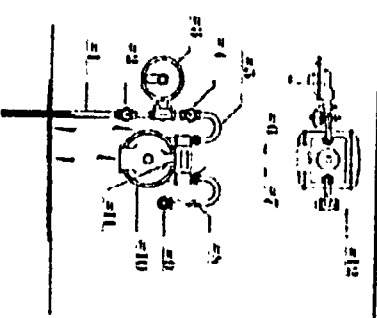

#1 Riser	#2 LP Cock	#3 Regulator
#4 LP Cock	#5 Inlet Loop	#6 Inlet Capswivel
#7 Out Capswivel	#8 Outlet Loop	#9 Fuel Line Fitting
#10 Gas Meter	#11 Index	#12 Fuel Line

Detection	Location	Soil Sub.	CG/EGD	Pressure	Surface	Pipe	Size	Weather
Mobile FI	Inside Bldg	Rock	(0-1)	Gas	Steel	✓	5-1.0	Clear
Flame Pack	Outside Bldg	Cluder	LEL	DIRT	PE	✓	2.0-3.0	Wet
Visual	Manhole	Clay	UEL	Asphalt	Cast Iron	✓	3.0-4.0	Hot (85-100)
CG/EGD	Undergrad	Loam	PPM	Concrete	CSST	✓	6.0-8.0	Cold (0-40)
Smart	Atmosphere	Sand		Sidewalk	PVCB	✓	10.0-11.0	

Leak Cause	Component/Explanation	Part of System	Type Material	Location Area	Repair Data
Corrosion	✓ Pipe	Transmission	Steel	Residential	1-5
Outside Ferric	Valve Leak Valve	Main	Cast Iron	Rural	5-Creater
Caustic/Defect	Fitting	Service	Ductile Iron	Commercial	Date Reported: 10-1-13
Material Defect	Regulator	Meter Set	Copper	Industrial	Date Rechecked:
Other	Tap Connection	Customer Pipe	Plastic		

*Leak repaired from leak survey. Repaired by Carey*



Address: 501 4th St Blvd. City: Jopkinsville / Monroe State: KY Date: 8-28-13

Had a small leak on the spud. Tightened down to fix the leak.

Case #	Grade 1	Grade 2	Grade 3
Classification	Grade 1	Grade 2	Grade 3
Meter #	Inside	Outside	
Manufacturer # 1			

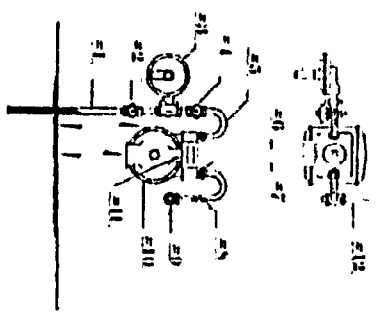

#1 Riser	#2 H/P Cock	#3 Regulator
#4 LP Cock	#5 Inlet Loop	#6 Inlet Cap/Swivel
#7 Out Cap/Swivel	#8 Outlet Loop	#9 Fuel Line Fitting
#10 Gas Meter	#11 Index	#12 Fuel Line

Detection	Location	Soil Sub	CG/EGCD	Pressure	Surface	Pipe	Size	Weather	
Mobile FI	Inside Bldg	Main		(0-1)	Grass	Steel	5-10	Clear	
Flame Pack	Outside Bldg	Service	CLL	(1-30)	Dirt	PE	20-30	Wet	
Visual	Manhole	Tap	UEL	(31-49)	Asphalt	Cast Iron	3.0-4.0	Hot (85-100)	
CG/EGCD	Undergrad	Valve	PPM	(51-99.9)	Concrete	CSST	6.0-8.0	Cold (0-10)	
Spud	Atmosphere	Meter		(100-399)	Sidewalk	PVCB	10.0-12.0		
Leak Cause		Component/Explanation		Part of System		Type Material		Location Area	
Corrosion	Pipe	Transmission	Steel		Residential		1-5	Bar	
Outside Force	Valve	Main	Cast Iron		Rural		5-Cremer	Coated	
Caustic Defect	Fitting	Service	Ductile Iron		Commercial		Date Repaired:		
Material Defect	Regulator	Meter Set	Copper		Industrial		Date Rechecked:		
Other	Tap Connection	Customer Pipe	Plastic						

Leak repaired from leak survey  
Repaired by Casey

10-1-13

Address: 610 W. 6th Street City: Tompkinsville, Monroe State: KY

New meter # 018940369  
 Reading: 1513  
 Old meter # 00A755293  
 Reading: 1960

We found a leak on the top of the lock valve. We broke down the meter set & discovered that lightning had ion in on the service & chipped the meter & spud. We replaced the faulty parts & exchanged the meter.

Case #	Grade 1	Grade 2	Grade 3
Classification	Grade 1	Grade 2	Grade 3
Meter #	Inside	Outside	
Manufacturer #			

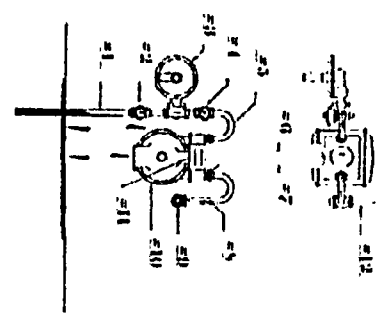

#1 Riser	#2 HP Cock	#3 Regulator
#4 LP Cock	#5 Inlet Loop	#6 Inlet Cap/Swivel
#7 Out Cap/Swivel	#8 Outlet Loop	#9 Fuel Line Fitting
#10 Gas Meter	#11 Index	#12 Fuel Line

Detection	Location	Soil Sub	CHUGCD	Pressure	Surface	Pipe	Size	Weather
Mobik FI	Inside Bldg	Main	Rock	(0-1)	Grass	Steel	5-10	Clear
Pume Pack	Outside/Id	Service	Cluder	(1-30)	Dirt	PE	2.0-3.0	Wrt
Visual	Manhole	Trap	Clay	(31-60)	Asphalt	Cast Iron	3.0-4.0	Hot (85-100)
CGTEGD	Undergrnd	Valve	Lamin	(61-99.9)	Concrete	CST	6.0-8.0	Cold (0-40)
Small	Atmosphere	Meter	Sand	(100-399)	Sidewalk	PVCB	10.0-12.0	

Leak Cause	Component/Explanation	Part of System	Type Material	Location Area	Repair Data
Corrosion	Flange	Transmission	Steel	Residential	1-5
Outside Force	Valve	Main	Cast Iron	Rural	5-Grater
Caust/Defect	Fitting	Service	Ductile Iron	Commercial	Date Repaired: 10-2-13
Material Defect	Regulator	Meter Set	Copper	Industrial	Date Rechecked:
Other	Tap Connection	Customer Pipe	Plastic		

Leak repaired from leak survey  
 Repaired by Carl

Leak found on a nipple in the meter set. We broke down the meter & re-labeled the leaking nipple to repair the leak.

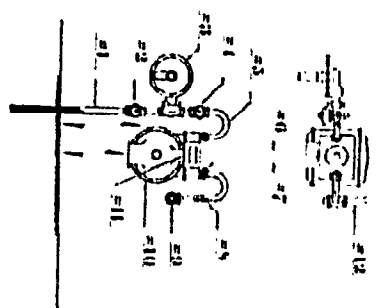

Detection	Location		Soil Sub.	CG/EGD	Pressure	Surface	Pipe	Size	Vent
	Inside Bldg	Outside Bldg							
Flame Pack	<input checked="" type="checkbox"/>	<input type="checkbox"/>	Rock		(0-1)	Grass	Steel	5-20	Clear
Visual	<input type="checkbox"/>	<input checked="" type="checkbox"/>	Clay	LEL	(1-30)	Dirt	PE	20-30	Ver
CG/EGD	<input type="checkbox"/>	<input type="checkbox"/>	Loam	UEL	(31-60)	Asphalt	Cast Iron	30-40	1101 (25-100)
Steel	<input type="checkbox"/>	<input type="checkbox"/>	Sand	PPM	(61-99.9)	Concrete	CSST	40-40	Code (4-40)
Leak Cause	Component/Explanation		Part of System		Type Material	Location Area	Repair Data		
Corrosion	<input checked="" type="checkbox"/>	Pipe	Transmission	Steel	Residential	1-5	Bare		
Outside Force	<input type="checkbox"/>	Valve	Main	Cast Iron	Rural	5-Greater	Coated		
Cond/Delet	<input type="checkbox"/>	Fitting	Service	Ductile Iron	Commercial	Date Repaired: 10-3-13			
Material Defect	<input type="checkbox"/>	Regulator	Meter Set	Copper	Industrial	Date Rechecked:			
Other	<input type="checkbox"/>	Tap Connection	Customer Pipe	Plastic					

Leak repaired from leak survey repaired by Gary



107 First St.

City of

Tompkinsville / Monroe

State: KY

Case #	Grade 1	Grade 2	Grade 3	Date
				8-15-13
Classification	Grade 1	Grade 2	Grade 3	
Meter #				
Manufacturer #				
	Inside	Outside		

The regulator was old + venting off excessively. We took the down the meter set + replaced the regulator to make the repair.

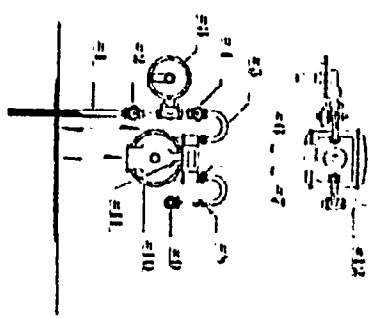

#1 Riser	#2 HP Cock	#3 Regulator
#4 LP Cock	#5 Inlet Loop	#6 Inlet Cap/Swivel
#7 Out Cap/Swivel	#8 Outlet Loop	#9 Fuel Line Fitting
#10 Gas Meter	#11 Index	#12 Fuel Line

Detection	Location	Soil Sub	CGI/CD	Pressure	Surface	Pipe	Size	Weather	
Mable FI	Inside Bldg	Main	Rick	(0-1)	Grass	Steel	5-2.0	Clean	
Flame Pack	Outside Bldg	Service	Cinder	(1-30)	Dirt	PE	2.0-3.0	Wet	
Visual	Manhole	Tap	Clay	(31-60)	Asphalt	Cast Iron	3.0-4.0	Hot (85-100)	
CGI/CD	Underground	Valve	Lamin	(61-99.9)	Concrete	CSST	6.0-4.0	Cold (0-40)	
Sand	Atmosphere	Meter	Sand	(100-399)	Sidewalk	PVCB	10.0-11.0		
Leak Cause		Component/Explanation		Part of System		Type Material		Location Area	
Corrosion	Pipe	Transmission	Steel		Residential		1-5	Bar	
Outside Force	Valve	Main	Cast Iron		Rural		5-Creater	Coued	
Coat/Defect	Fitting	Service	Ductile Iron		Commercial		Date Repaired:		
Material Defect	Regulator	Meter Set	Copper		Industrial		Date Rechecked:		
Other	Tap Connection	Customer Pipe	Plastic						

Leak repaired from leak survey  
Repaired by Carey

10-3-13

RECEIVED

NOV 20 2013

PUBLIC SERVICE  
COMMISSION

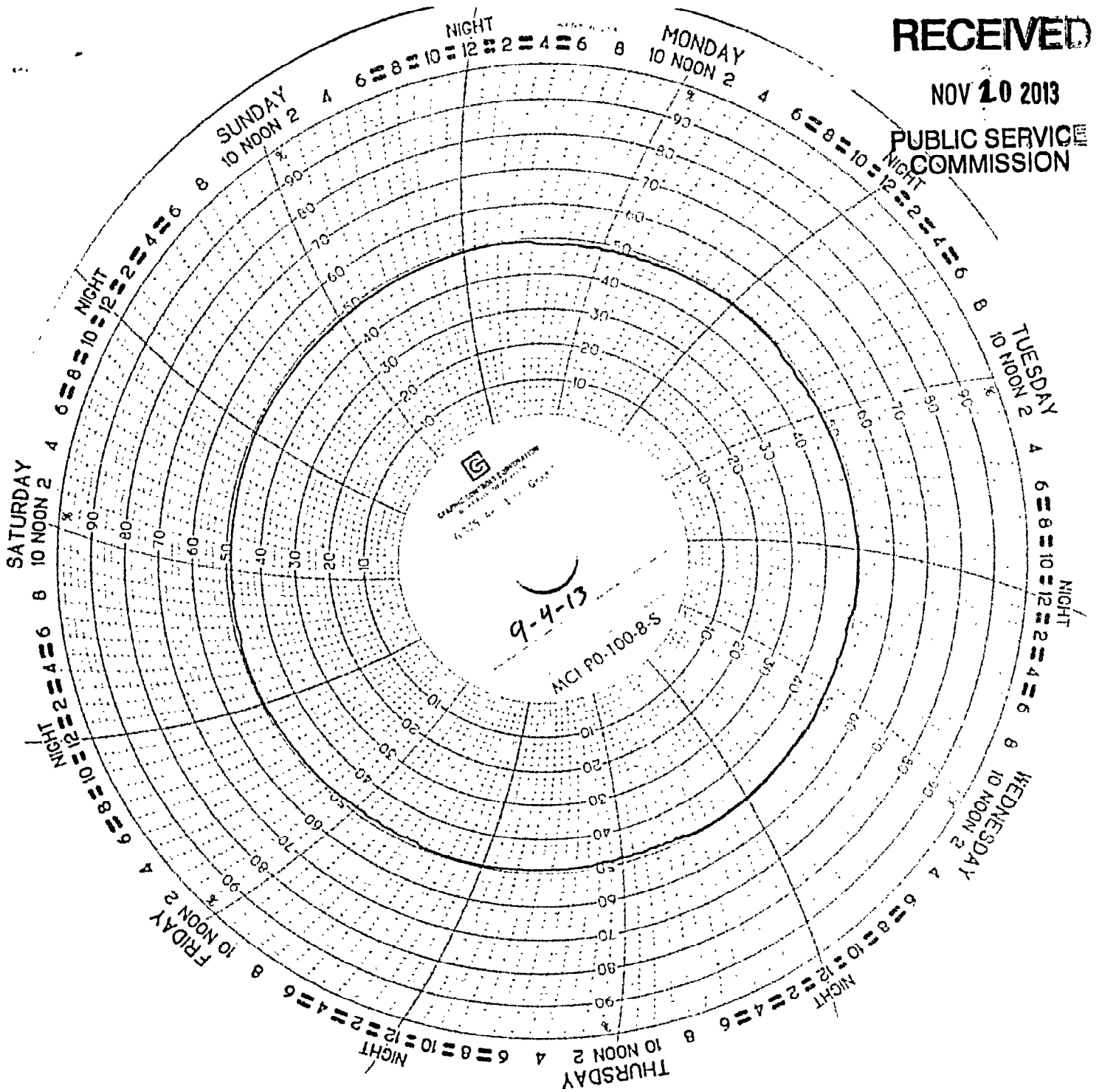

Tompkinsville  
Office Chart Clock



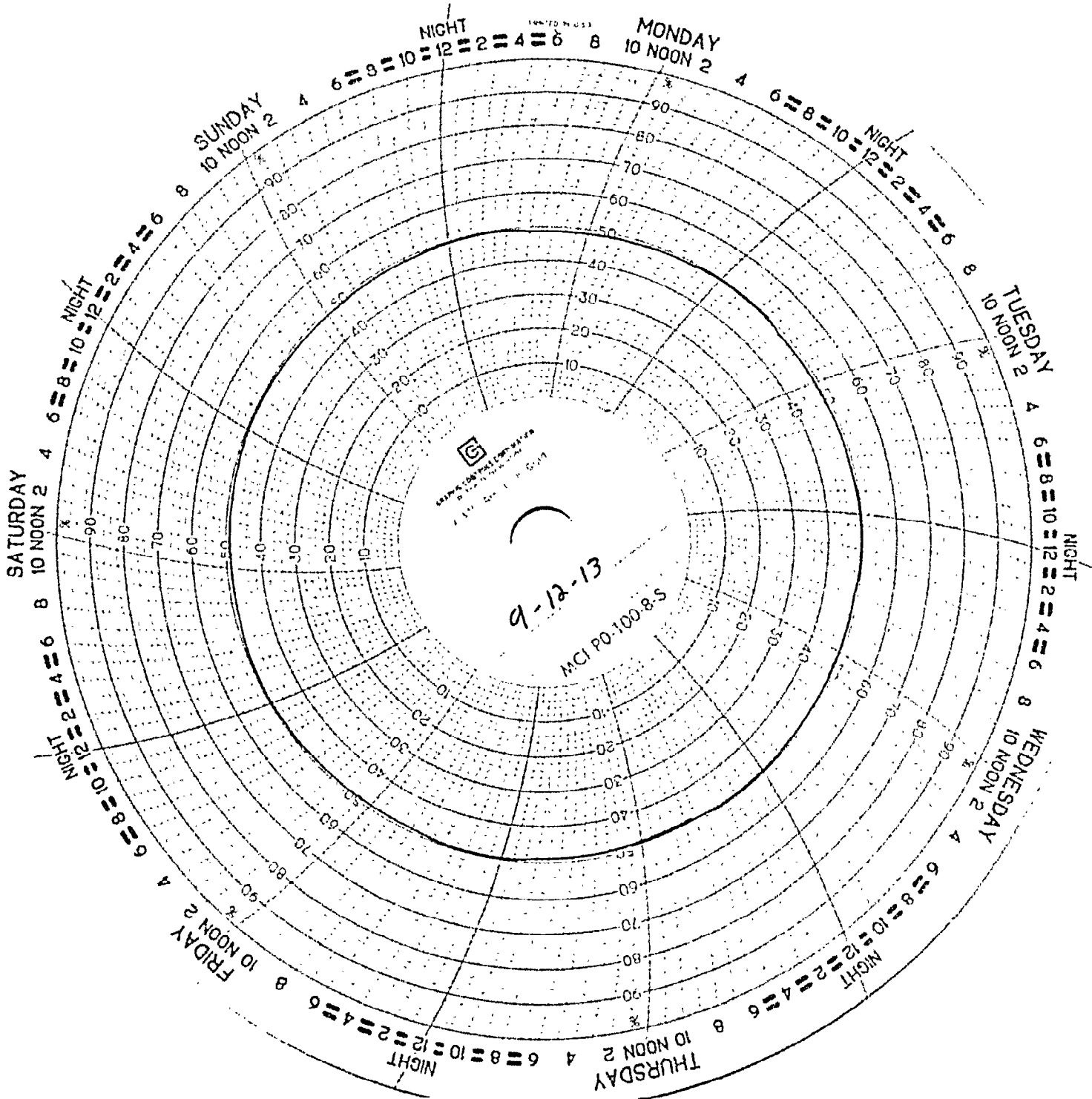

City of Tompkinsville  
Office Chart Clock.



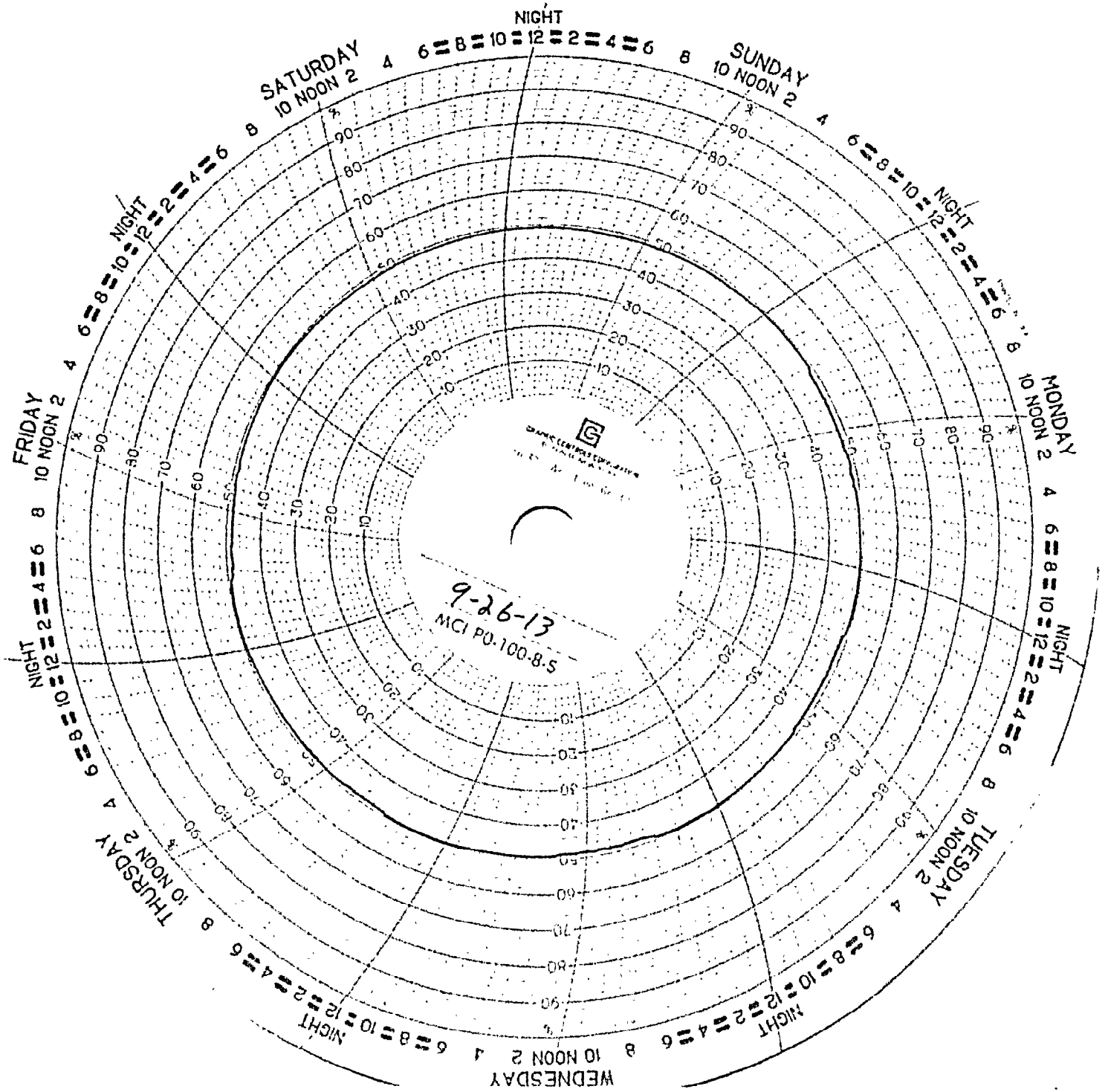

Tomp Kinsville  
Office Chart Clock  
Ann Warner

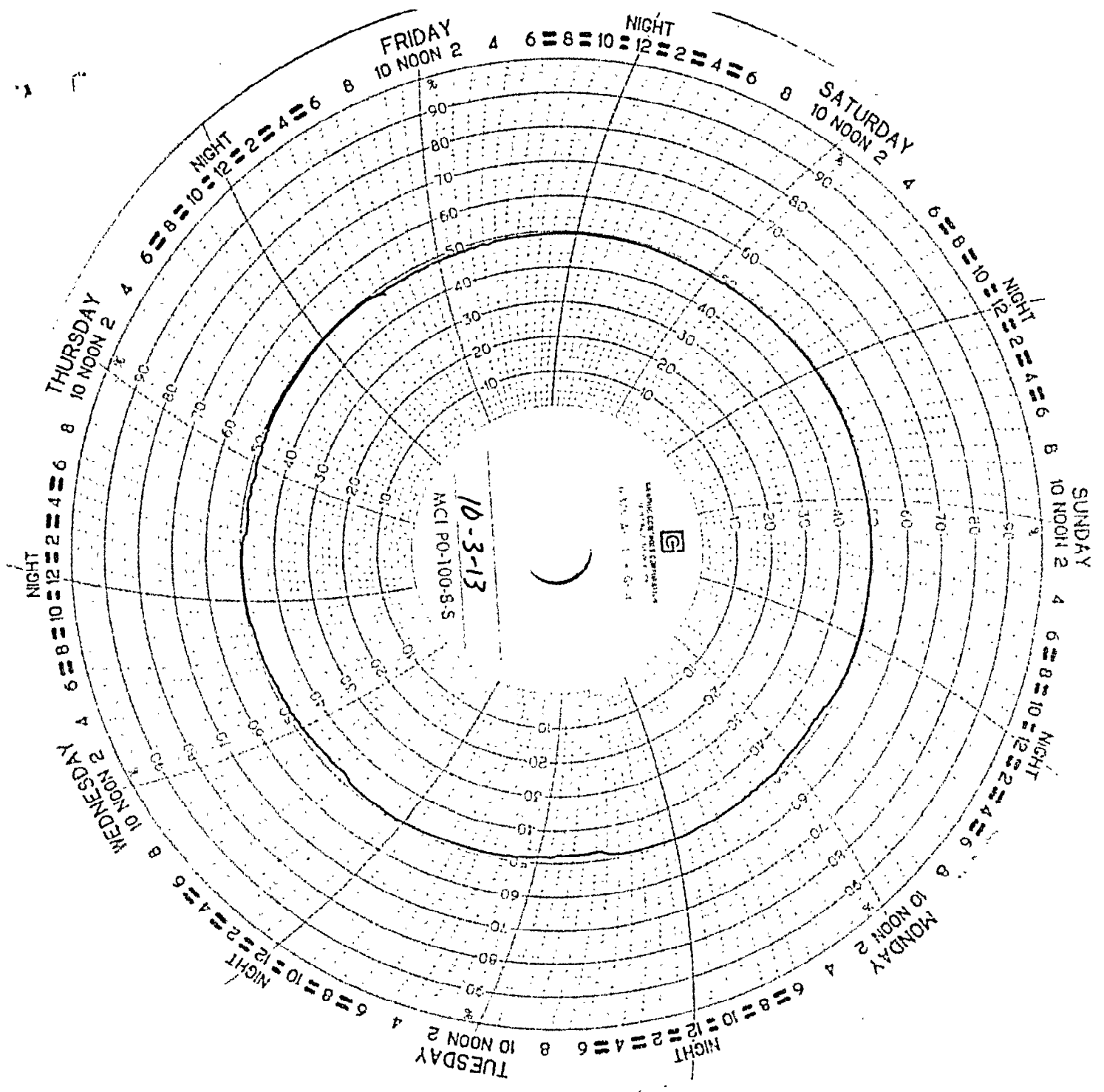

Tompkinsville Office  
Chart Clock

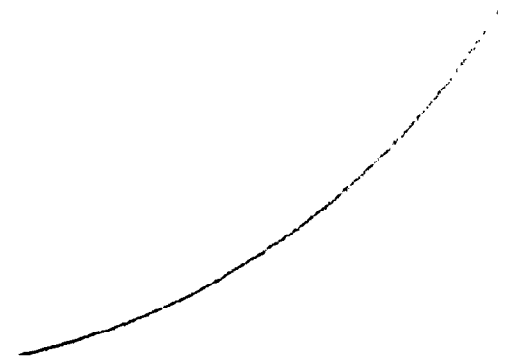
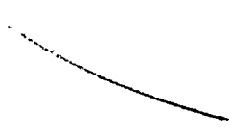

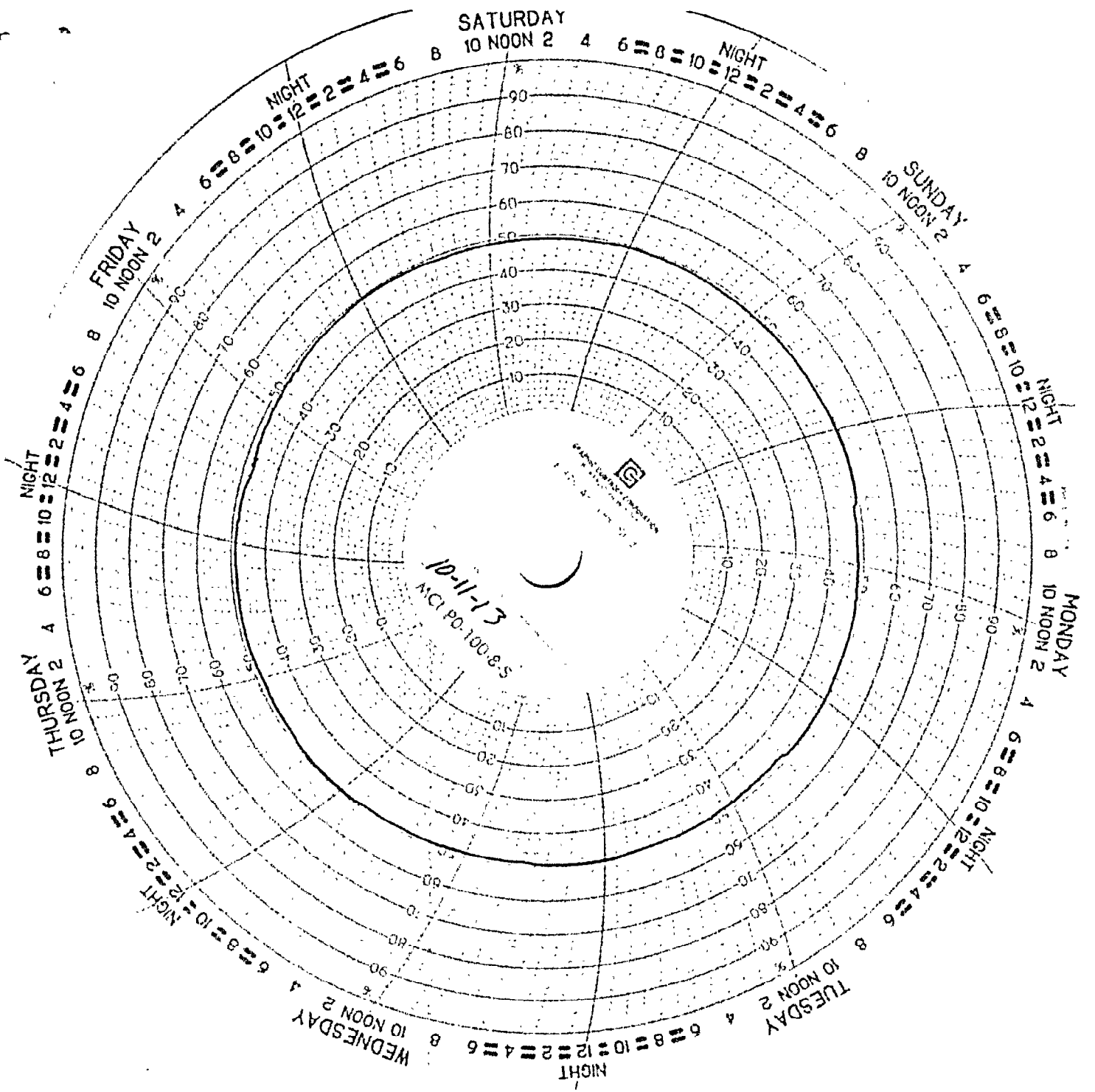

Tompkinsville  
Office Chart Clock

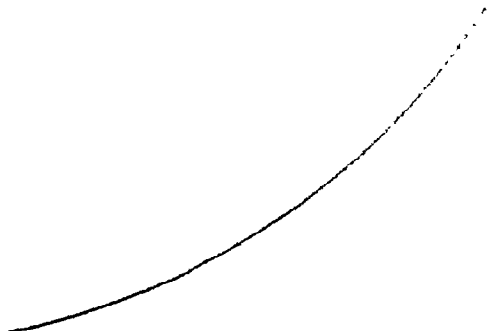

SUNDAY

10 NOON 2 4 6 8 10 12

NIGHT

NIGHT

SATURDAY

10 NOON 2 4 6 8 10 12

MONDAY

10 NOON 2 4 6 8 10 12

NIGHT

TUESDAY

10 NOON 2 4 6 8 10 12

NIGHT

WEDNESDAY

10 NOON 2 4 6 8 10 12

NIGHT

THURSDAY

10 NOON 2 4 6 8 10 12

FRIDAY

10 NOON 2 4 6 8 10 12

NIGHT



GRAPHIC CONTROLS CORPORATION

1512 Ave. Lee Ferry

10-18-13

MCI PO 100-8-5

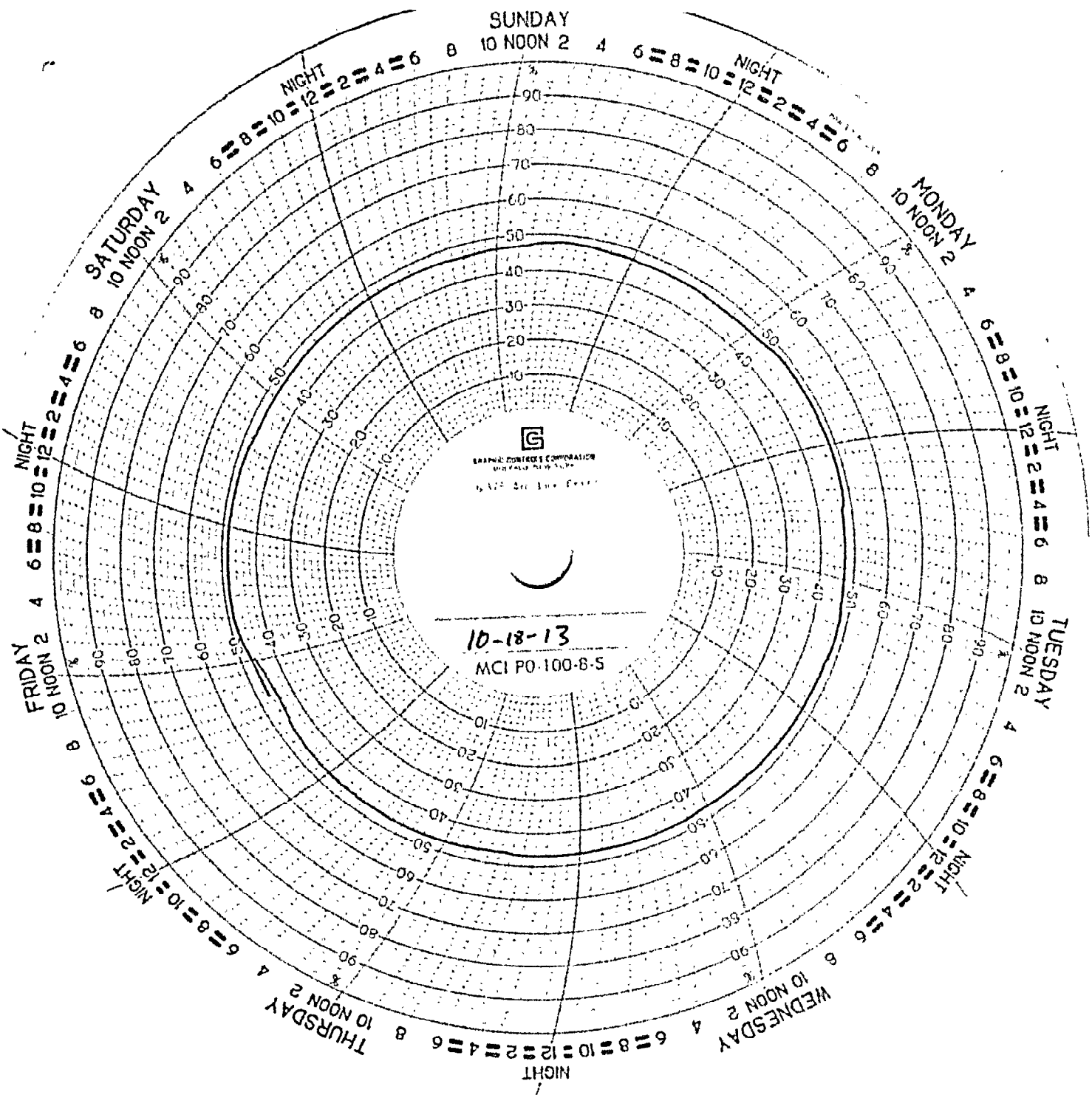

City of Tompkinsville  
office chart.





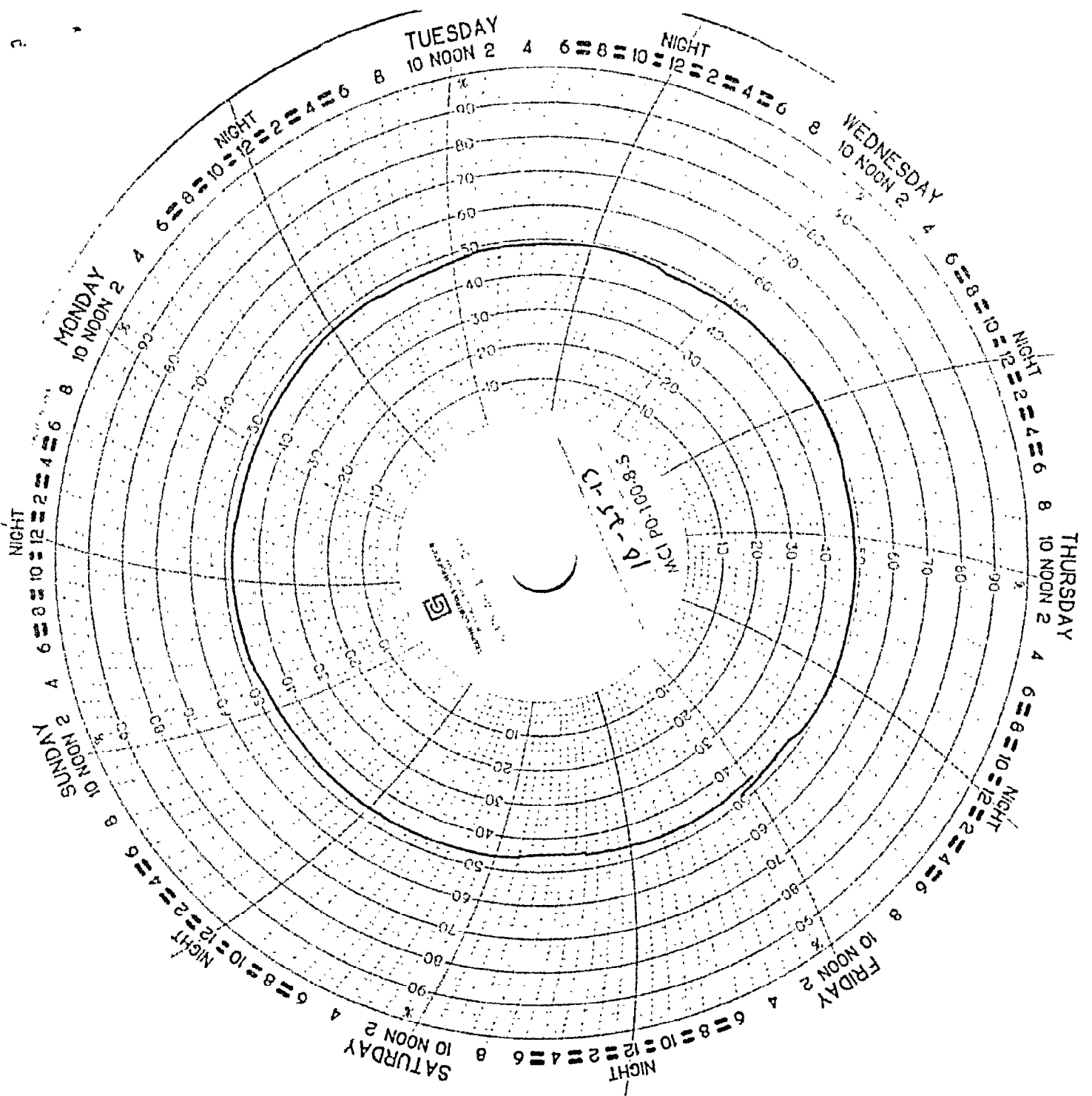

Tompkinsville City  
Office Chart.

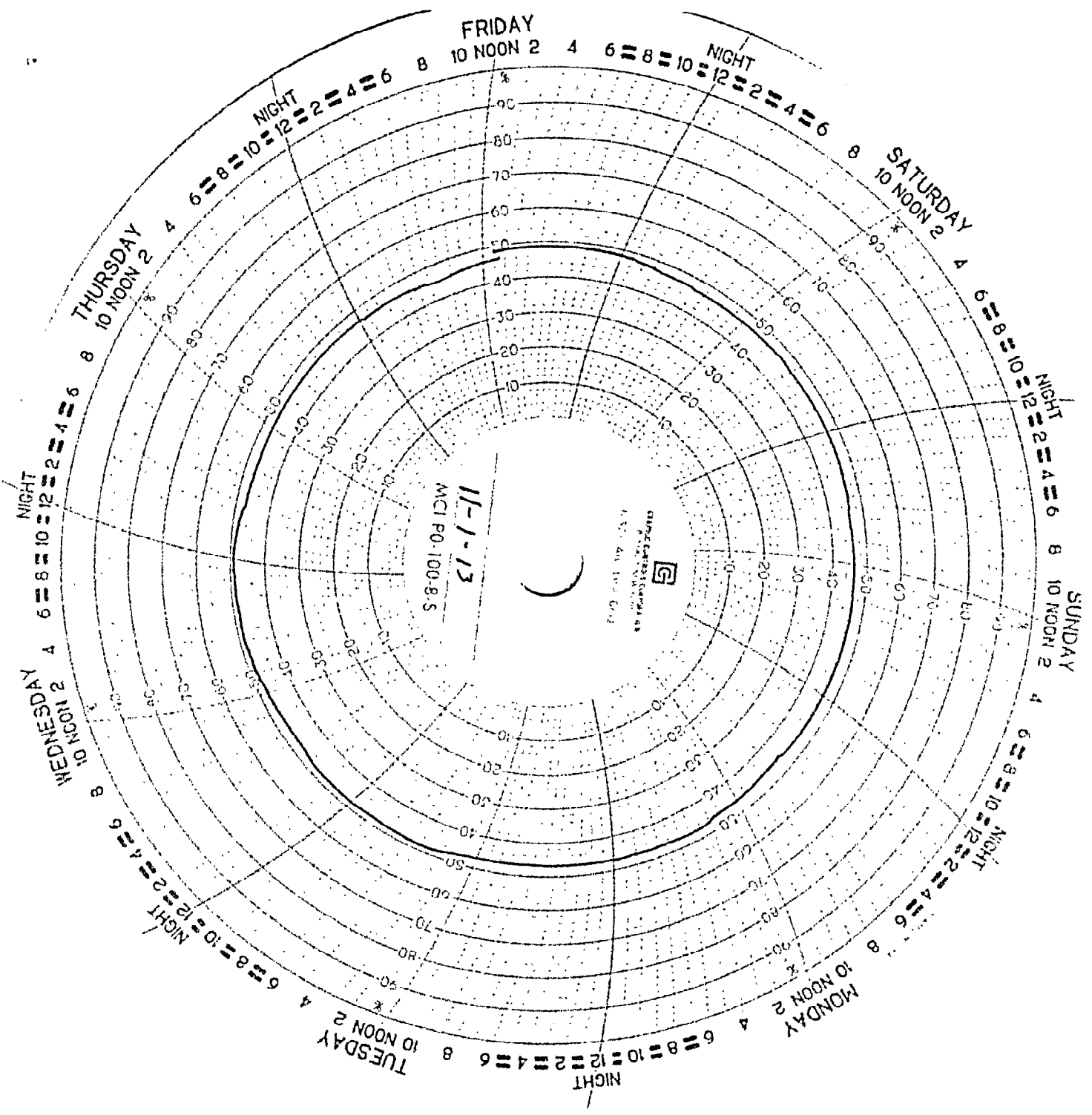

11-1-13

MCI (MO) 100-8-S

UNITED STATES  
DEPARTMENT OF  
COMMERCE  
MARINE WEATHER SERVICE



City of Tompkinsville  
office chart clock.

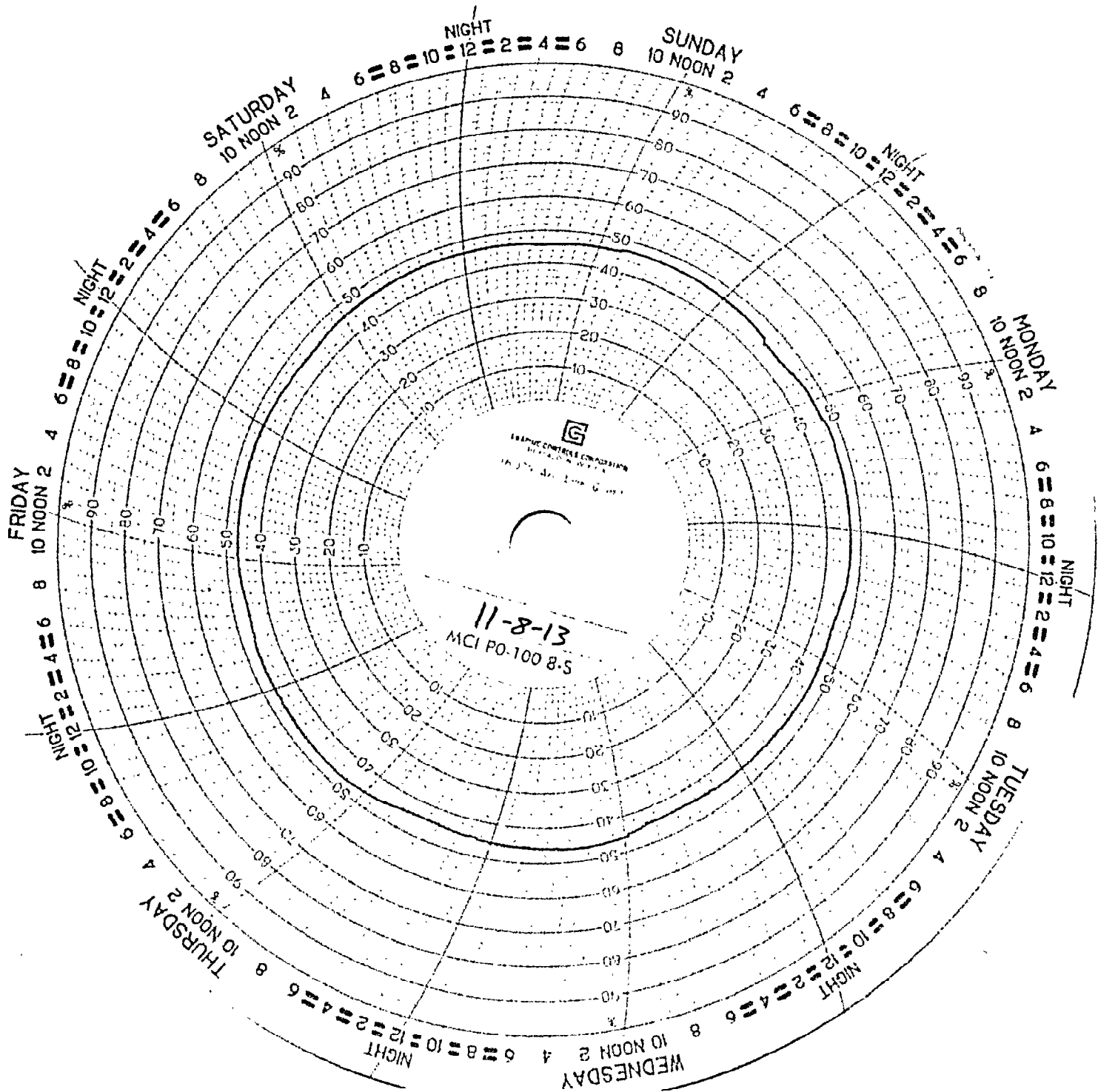

City of Tompkinsville  
Office Chart Clock



# City of Tompkinsville

"811"

## Public Awareness Meeting

October 1, 2013

Name	Organization	Phone	Email
Joe Crazen	RussMar		
Jason Warren	Russ Mar		
<del>Shawn Martin</del>	<del>Russ Mar</del>		
Jeff Proffitt	Tompkinsville Mark		
Jerry Monday	JRS Plumbing Supply		

**Public Meeting**

**ATTENTION ALL CONTRACTORS,  
BUSINESS OWNERS AND CITY RESIDENTS:**

RussMar will be having a public informational meeting on October 1, 2013 at 4:30 p.m. at the Economic Development Center. The meeting will be a discussion of utility locates, meter disconnects, along with general information about RussMar and their responsibilities with the City of Tompkinsville.

(092602)

RECEIVED

NOV 20 2013

PUBLIC SERVICE  
COMMISSION

# City of Tompkinsville

"Public Awareness Plan"

Thursday, October 24, 2013

City Council Meeting 6:00 PM

	NAME	ORGANIZATION	PHONE	EMAIL
1.	Joe Orazen	RussMar		
2.	Kerry McPherson	MCWD		
3.	Crystal McPherson	City of Tompkinsville		
4.	Reed N. Moore, Jr.	City		
5.	Drew Thompson	Gilbert + Gilbert		
6.	Ricky Richardson	commissioner		
7.	Sherry Crawford	Commissioner		
8.	PROL Embert (e)			
9.	Tommy Walden	City		
10.	Phyllis Reaga	Monor Co Enis/ES11		
11.	Donna Egan	Tompkinsville News		
12.		TOMPINSVILLE		
13.	Jeff Proffitt	Mayor		
14.	Pat Fowl	Chief of Police		
15.	Randall Hagan	City of T-ville		
16.	John Hilda	T-ville		
17.	Mozw + Kevin	City of Trille		
18.				
19.				
20.				



The City of  
Tompkinsville

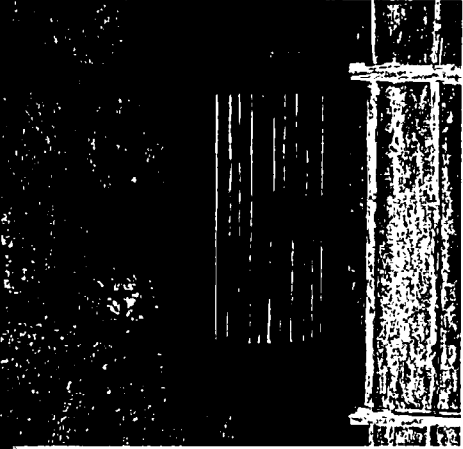

# Natural Gas Pipeline & Public Safety

**Presented By:**

*RussMar Logistics, LLC.*

2371 Irvine Road

Richmond, Kentucky 40475

Telephone:

Fax:

# **Purpose of Presentation...**

**The City of Tompkinsville in accordance with federal regulations is required to periodically communicate with its customers, constituents, government leaders and public safety personnel about our system's purpose, reliability, associated hazards, and damage prevention, as well as emergency preparedness measures.**

# **About Natural Gas...**

**\*Demand for natural gas in the United States continues to grow. Residential customers as well as commercial, industrial and electric generation customers know that it's safe, reliable and efficient.**

**\*Today, nearly 3 out of 5 U.S. homes are heated with natural gas.**

**\*Domestically produced natural gas is transported to 160 million customers through a 1.6 million mile pipeline system.**

**\*The City of Tompkinsville maintains approximately 18 miles of gas line infrastructure that serves more than 1,500 customers.**

# About Natural Gas Lines...

Main gas lines branch into household service lines.

Pipes are typically made of “caution yellow” plastic or tar-coated steel which helps prevent corrosion.

Main gas lines are typically 1-4-inches in diameter and are located roughly two-feet below the surface.

Service gas lines are typically a 1/2 - inch to 3/4-inches in diameter and buried 12- to 18-inches below the surface.



# The Smell of Natural Gas.

Natural gas is odorless and colorless in its pure state

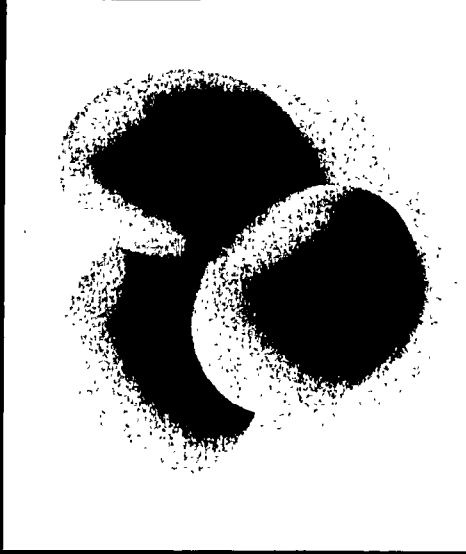

The odor associated with natural gas is added by gas companies to enable detection.

- Natural gas is lighter than air and will rise and disperse in an open area.
- Natural gas may ignite when properly mixed with air.
- To burn, natural gas must make up no less than 4% or more than 16% of a given volume of air.

# How to Recognize A Gas Leak...

Gas pipeline leaks are uncommon, but it is a good idea to know how to recognize them.

## Common signs include:

- ❖ *A gas odor (rotten eggs)*
- ❖ A blowing or hissing sound
- ❖ Water bubbling or being blown into the air at a pond, creek or river
- ❖ Brown patches in vegetation or near a right-of way
- ❖ Dry spot in moist field.



# **What To Do About a Natural Gas Leak..**

**If you detect any signs of a gas pipeline leak, follow these steps:**

- ❖ **Leave area at once. Warn others to stay away**
- ❖ **Avoid using ignition sources such as cigarettes, motor vehicles or electrical switches**
- ❖ **If the situation warrants, call the local fire department**
- ❖ **Do not try to extinguish a gas fire or operate any pipeline valves**
- ❖ **Anytime you suspect a gas leak or potential gas emergency, call 911.**

# **Natural Gas Pipeline Safety**

Pipelines are the safest, most reliable and efficient manner of transporting energy products.



**Pipelines exist almost everywhere throughout the United States**

Everyone can contribute to safety and security by knowing where pipelines are in their community and recognizing unauthorized activity or abnormal conditions.

To find out who operates pipelines in your area, visit the *National Pipeline Mapping System* available online at:

[www.npms.rspa.dot.gov](http://www.npms.rspa.dot.gov).



# Natural Gas Pipeline Safety

One of the greatest single challenges to safe natural gas pipeline operations is the accidental damage caused by excavation, directional drilling, construction, farming activities, or even homeowner's digging in their yards!

*The City of Tompkinsville* is especially concerned about digging around any pipeline since the release of natural gas or other highly volatile liquids can have damaging results.

Don't ever assume that you know where the underground utilities are located.

Before starting any work, the law requires that you call 811 at least 48 hours before you do any extensive digging or construction on your property or on public lands.



# What is 811?

Kentucky 811 is a free statewide computer operated communication system, designed to save time, money, costly lawsuits, and dramatically reduce accidental dig-ins.

Kentucky 811 is a non-profit corporation made up of operators of underground facilities within the State of Kentucky.



**Know what's below.**

**Call before you dig.**

# ***The City of Tompkinsville Natural Gas Line Damage Prevention Program***

interruptions and possible hazardous situations by calling **811** before you dig at least 48 hours before doing any extensive digging or construction on your property or on public lands.

❖ We will let you know if lines are in your area by marking their location with yellow flags for gas and blue flags for water lines.

❖ Cooperation is essential in avoiding needless disruption of natural gas and water service by unintentional digging in our service area.

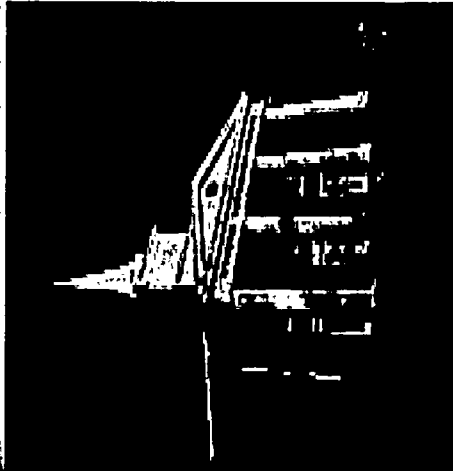

***The City of Tompkinsville  
Natural Gas Line Damage Prevention  
Program***

**If you do not call and you  
hit an underground line,  
you could be hurt or killed.**

**You may also be held liable  
for costly damages.**



# **Here Are Some Simple Excavation Safety Steps**

**mark the dig sites in white paint.**

**✓ Call Before You Dig – It's the law!  
At least two working days (48 hours) prior to starting work. Call 811.**

**✓ Respect the Marks – Maintain visibility of the marks and safely follow them when digging.**

**✓ Dig with Care – Hand excavate within 24 inches of each side of the lines.**

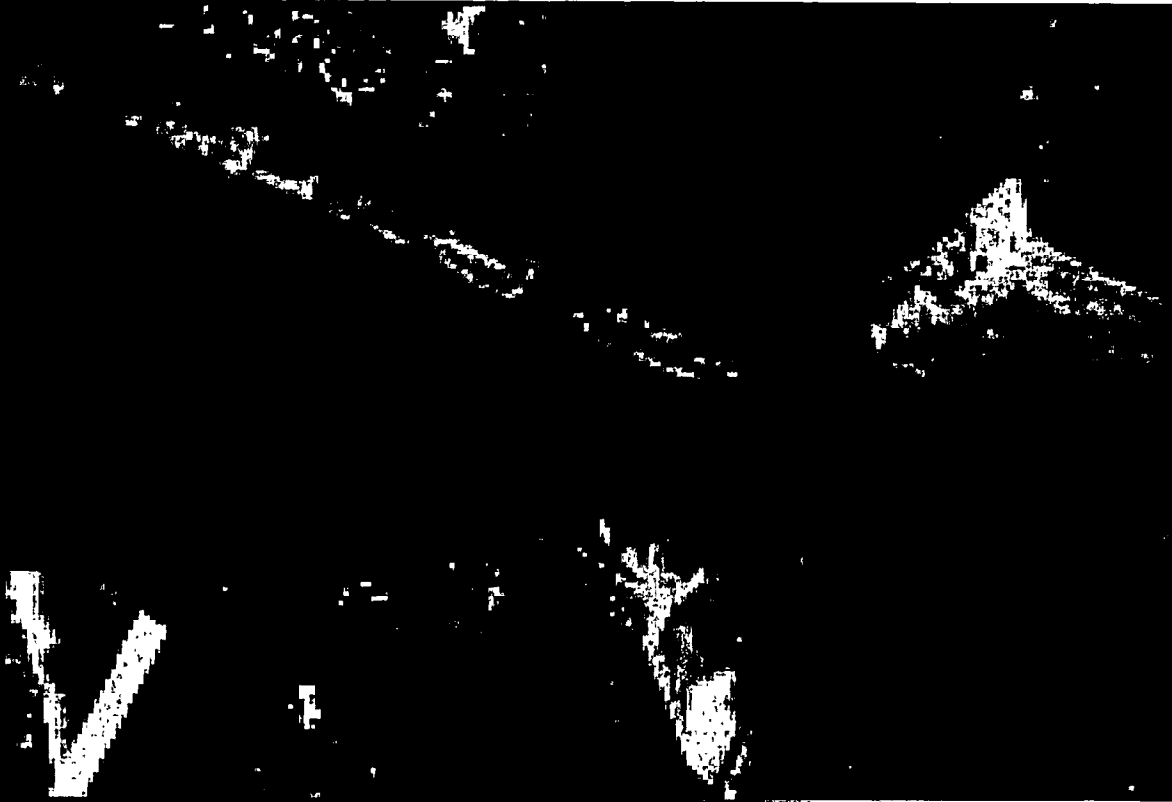

# ***If Your Equipment Contacts a Natural Gas Line***

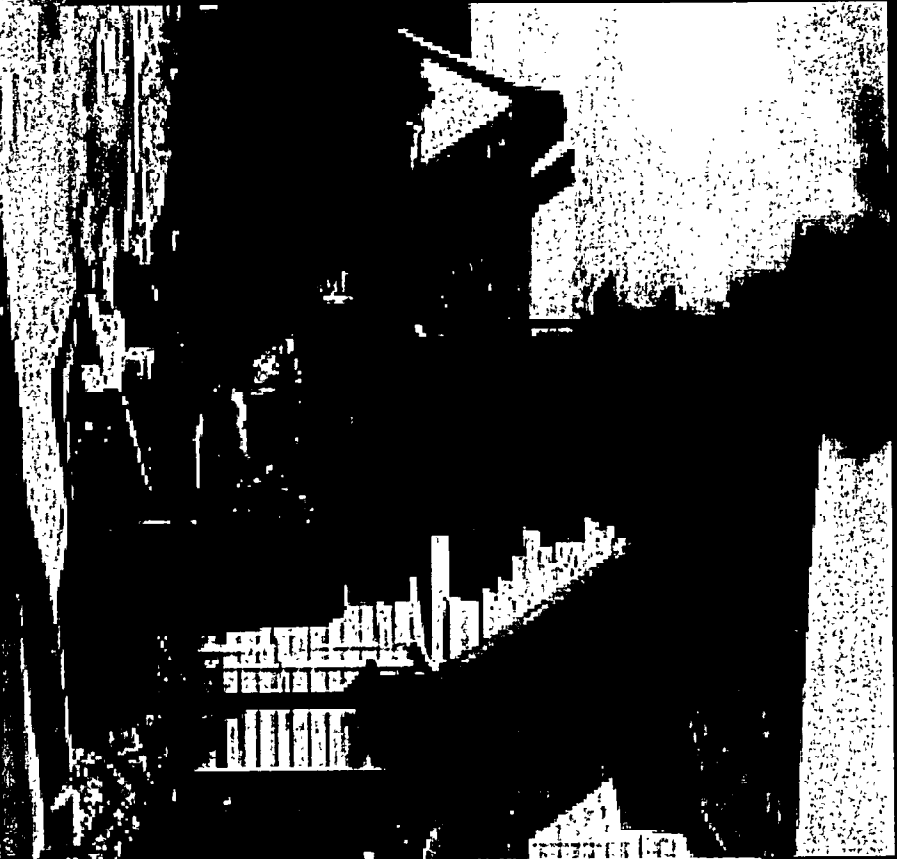

- engines or generators.***
- ✓ Warn Others and Leave - the area quickly.***
- ✓ Do Not Operate - any gas pipeline valves or stop the flow of gas.***
- ✓ Leave the excavation open.***

***In a natural gas emergency, call 911, then the City of Tompkinsville at (270) 487-6776, Monday through Friday, 7:30 a.m. to 4:00 p.m. For after hours emergencies, call the Police Department at (270) 487-6191.***

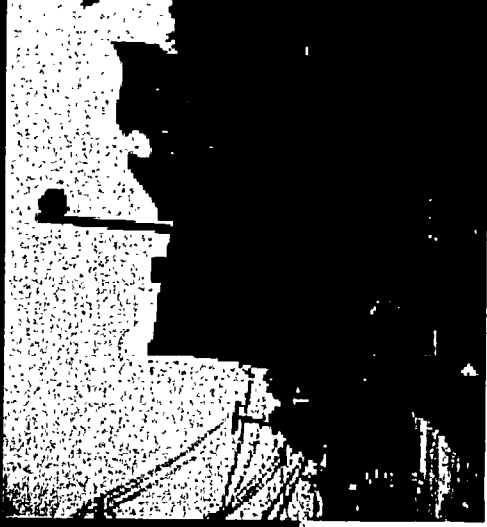

***We welcome the opportunity to further discuss our efforts to keep our various constituent groups apprised of our safety measures and response plans, and we appreciate your support in providing the highest level of service to our community. Thank you for your time and attention.***

